



Liebert XD

Parts Manual



Model Number Designations	8
Supplemental Zone and Spot Cooling (Pumped Refrigerant Based) - 60Hz	9
Supplemental Zone and Spot Cooling (Water Based) - 60Hz	10
Liebert XDA	11
1. XDA AIRMOVER ASSY	11
1.1. Relay	12
1.2. Fan	12
1.3. Cord.....	12
1.4. Bracket	13
1.5. Bracket Relay	13
Liebert XDV	14
2. XDV ASSEMBLY	14
2.1. Cover	15
2.2. Grille	15
2.3. Plate Fan Mounting.....	15
2.4. Bracket Mounting.....	15
2.5. Cord Line Retainer Clip	16
2.6. Filter/Drier	16
2.7. Valve Access Body	16
2.8. Valve Core Refrigerant	17
2.9. Circuit Breaker	17
3. Plate Mounting Assembly	18
3.1. Plate Fan	18
3.2. Fan Motor	19
3.3. Relay	19
3.4. Guard Finger	19
4. Accessories	20
Liebert XDC	21
5. XDC EP ASSEMBLY	21
5.1. DeadFront XDC	22
5.2. Standoff Disconnect.....	23
5.3. Collar	23
5.4. PWA Converter.....	23
5.5. FuseBlock.....	24
5.6. FuseBlock.....	24
5.7. Switch Disconnect	24
5.8. Relay	25
5.9. Transformer	25
5.10. PWA Control	25
5.11. Plate Back	26
5.12. FuseBlock.....	26
5.13. Fuse Dual Element	26
5.14. Contactor	27
5.15. Contacts	27
5.16. Handle Disc	27
5.17. Plate Disc	28
5.18. Label Disconnect	28
5.19. Ground Lug.....	28
6. EP XDC 460/480V 2 PUMP.....	29
6.1. DeadFront XDC	30
6.2. Collar Locking Disconnect	31
6.3. Terminal Lug.....	31
6.4. FuseBlock Buss.....	31
6.5. FuseBlock.....	32
6.6. Transformer	32

6.7.	Standoff Disconnect.....	32
6.8.	Switch Disconnect	33
6.9.	Fuse Dual Element	33
6.10.	Fuseblock	33
6.11.	Contactora	34
6.12.	Transformer	34
6.13.	Fuse.....	34
6.14.	Fuse.....	35
6.15.	Power Supply.....	35
6.16.	Terminal Strip	35
6.17.	Terminal Strip End.....	36
6.18.	PWA Universal Control	36
6.19.	PWA ISO XFMR/Fuse	36
6.20.	Fuse Kit	37
6.21.	Fuse Glass	37
6.22.	Fuse Glass	37
6.23.	FuseBlock.....	37
7.	DSCH STACK GRUNDFOS.....	38
7.1.	Valve Check	38
7.2.	Valve Ball.....	39
7.3.	Valve Access Body	39
7.4.	Valve Core Refrigerant	39
7.5.	Adapter	39
8.	Piping Configuration	40
8.1.	Compressors	40
8.1.1.	HX CSCDE Condenser.....	40
8.1.2.	XDC Compressor Mount.....	41
8.2.	Suction Lines	43
8.2.1	XDC Suction Circuit.....	44
8.2.1.1	Valve Access Body	44
8.2.1.2	Valve Core Refrigerant	44
8.2.1.3	Valve Comp Serv.....	45
8.3.	Discharge Lines	45
8.3.1	XDC Comp1/ Comp2 Discharge.....	46
8.3.1.1	Check Valve.....	46
8.3.1.2	Valve Comp Serv.....	46
8.3.1.3	Valve Access Body	47
8.3.1.4	Valve Core Refrigerant	47
8.3.3	Clamp Tube	47
8.4.	HGBP and Liquid Return Lines.....	48
8.4.1	XDC HGBP Assembly	48
8.4.1.1	Valve Solenoid.....	49
8.4.1.2	Valve Electronic HGBP.....	49
8.4.2	Clamp Tube	49
8.5.	Liquid Return Stacks and Clamps.....	50
8.5.1	XDC Liquid Line.....	50
8.5.1.1	Valve Exp	51
8.5.1.2	Filter/Drier.....	51
8.5.1.3	Valve Solenoid.....	51
8.5.1.4	Liquid Indicator	52
8.5.1.5	Valve Ball Refrigerant.....	52
8.5.1.6	Valve Access Body	52
8.5.1.7	Valve Core Refrigerant	52
8.6.	Pumps and Receiver	53
8.6.1	Pump	53
8.6.2	Valve Relief	54
8.7.	Pumps Suction Lines	54
8.7.1	Suction Line.....	55
8.7.1.1	Valve Ball Refrigerant.....	55
8.7.1.2	Valve Access Body	55
8.7.1.3	Valve Core Refrigerant	56

8.7.2	Clamp Tube	56
9.	Filter/Drier Replace Assembly	57
9.1.	Filter Drier	57
9.2.	Valve Ball	58
9.3.	Valve Relief	58
9.4.	Valve Access Body	58
9.5.	Valve Access	59
9.6.	Valve Core Refrigerant	59
10.	Press Switch Assembly	59
10.1.	Pressure Switch	60
10.2.	Pressure Switch	60
11.	Accessories	60

Liebert XDO 61

12.	XDO16 w/ COND Detection	61
12.1.	Panel	61
12.2.	End Panel	62
12.3.	PowerBlock	62
12.4.	Angle Evap Coil	62
12.5.	Clamp Insulated Metal	63
12.6.	Clamp Insulated Metal	63
13.	XDO Unit Assembly 208V	64
13.1.	Panel	65
13.2.	Coil Assy Left	65
13.3.	Coil Assy Right	65
13.4.	Plate Cover	66
13.5.	Panel Top Rear	66
13.6.	Valve Access Body	66
13.7.	Valve Core Refrigerant	66
13.8.	Clamp Insulated Metal	67
13.9.	Filter/Drier	67
13.10.	Regulator	67
13.11.	Panel Top Front	68
14.	BOX ELEC ASSY 208V XDO	68
14.1.	Cover Elec Box	68
14.2.	PowerBlock	69
14.3.	Bracket Cap	69
14.4.	Capacitor	69
14.5.	Terminal Strip	70
14.6.	Terminal Strip	70
15.	TRAY FAN ASSY W/ LIQUID SENSOR 230V	71
15.1.	Fan Axial	71
15.2.	Switch Rocker	72
15.3.	Capacitor	72
15.4.	Bracket Cap	72
15.5.	Circuit Breaker	73
15.6.	Boot Cap	73
16.	PIPING ASSY XDO16	73
16.1.	Valve Core Refrigerant	74
16.2.	Clamp Tube	74
17.	SUPPLY PIPING ASSY XDO 16	75
17.1.	Regulator	75
17.2.	Filter/Drier	76
17.3.	Valve Access Body	76
17.4.	Accessories	76

Liebert XDP 77

18.	XDP EP ASSY 460V 2PUMP	77
18.1.	DeadFront CDU	78
18.2.	FuseBlock	78

18.3.	Transducer	79
18.4.	Terminal Lug.....	79
18.5.	Switch Disconnect	79
18.6.	Transformer	80
18.7.	Circuit Breaker	80
18.8.	Contactors	80
18.9.	Transformer	81
18.10.	Fuse.....	81
18.11.	Fuse.....	81
18.12.	Terminal Strip	82
18.13.	Terminal Strip End.....	82
18.14.	Power Supply.....	82
18.15.	PWA Control.....	83
18.16.	PWA XFMR/Fuse	83
18.17.	Fuse Kit	83
18.18.	Fuse Glass	84
18.19.	Fuse Glass	84
18.20.	FuseBlock.....	84
19.	Pump.....	85
19.1.	Kit Pump	85
20.	Piping Configuration XDP 160.....	86
20.1.	CW Return Valve Assembly	87
20.1.1	Valve 2-Way	88
20.1.2	Motor	88
20.1.3	ELL Short Rad	88
20.1.4	Valve Access Body.....	88
20.1.5	Valve Core Refrigerant	89
20.2.	Heat Exchanger.....	89
20.3.	Press Switch.....	89
20.4.	Valve Relief	90
20.5.	Ell Brass	90
21.	Suction Line Grundfos.....	91
21.1.	Valve Ball.....	91
21.2.	Valve Access Body.....	91
21.3.	Valve Core Refrigerant	92
21.4.	Adapter	92
22.	DSCH STACK GRUNDFOS LFT XDP160	93
22.1.	Valve Check	93
22.2.	Valve Ball.....	94
22.3.	Valve Access Body.....	94
22.4.	Valve Core Refrigerant	94
22.5.	Adapter	94
23.	DSCH STACK GRUNDFOS RT XDP160	95
23.1.	Valve Ball.....	95
23.2.	Valve Check	96
23.3.	Valve Access Body.....	96
23.4.	Valve Core Refrigerant	96
23.5.	Adapter	96
24.	DSCH LINE 2GRUNDFOS XDP160	97
24.1.	Valve Access Body.....	97
24.2.	Adapter CU.....	98
24.3.	Valve Core Refrigerant	98
25.	Panel Options Configurations 100KW CDU	98
25.1.	Back Panel	99
25.2.	Side Panel	99
25.3.	Left Door.....	99
25.4.	Right Door	100
26.	Filter Drier Replace Assembly.....	100
26.1.	Filter Drier	101
26.2.	Valve Ball.....	101
26.3.	Valve Relief	101

26.4.	Valve Access Body	102
26.5.	Valve Core Refrigerant	102
26.6.	Valve Access	102
27.	Accessories	103

Liebert XDWP 104

28.	CDU EP ASY	104
28.1.	Fuse Kit	105
28.2.	DeadFront XDP	106
28.3.	Transformer	106
28.4.	Transducer	107
28.5.	Terminal Lug	107
28.6.	Standoff Disconnect	107
28.7.	Collar Locking Disconnect	108
28.8.	Switch Disconnect	108
28.9.	Transformer	108
28.10.	Circuit Breaker	109
28.11.	Contactors	109
28.12.	Handle Disconnect	109
28.13.	Label Disconnect	110
28.14.	Terminal Strip	110
28.15.	Terminal Strip End	110
28.16.	Power Supply	111
28.17.	FuseBlock	111
28.18.	Fuse Dual Element	111
28.19.	PWA Universal Control	112
28.20.	PWA ISO XFMR/FUSE	112
28.21.	Fuse Kit	112
28.22.	Fuse Glass	113
28.23.	Plate Disconnect	113
28.24.	FuseBlock	113
28.25.	Fuse Glass	114
28.26.	Fuse FNQ	114
28.27.	Fuse FNQ	114
28.28.	Lamp	115
28.29.	Lamp	115
29.	DSCH PUMP STACK ASSY XDWP 60HZ	116
29.1.	Valve Check	116
29.2.	Valve Ball Switch	117
30.	BASE ASSY CONFIG XDWP	117
30.1.	Pump	118
30.2.	Heat Exchanger FlatPlate	118
30.3.	Valve Access Body	119
31.	VLV/CSTM/STND CONN XDWP	119
31.1.	Valve Ball Bronze	120
31.2.	Valve Boiler	120
32.	STAND PIPE ASSY XDWP	121
32.1.	Valve 2-Way	121
32.2.	Valve Core Refrigerant	121
33.	PIPING CONFIG XDWP 60HZ	122
33.1.	Transducer	122
33.2.	Clamp Tube	123
33.3.	Clamp Insulated Metal	123
33.4.	Stand Pipe Assy	123
31.4.1	Valve Access Body	124
31.4.2	Valve Core Refrigerant	124
33.5.	CW Return Line	124
31.5.1	Valve 2-Way	125
31.5.2	Valve Access Body	125
31.5.3	Valve Core Refrigerant	125

33.6.	Supply Line Assembly	126
31.6.1	Valve 2-Way	126
31.6.2	Valve Core Refrigerant	127
33.7.	Flow Switch Assembly	127
31.7.1	Switch Flow.....	127
33.8.	Motor	128
33.9.	Gauge Water Compressor.....	128
33.10.	Thermowell Brass.....	129
34.	SUCTION PUMP STACK XDWP	129
34.1.	Valve Ball Switch	130

Liebert XDWR..... 131

35.	BASE FRAME ASSY RACKCOOLER	131
35.1.	Coil Complete Rack Cooler	131
35.2.	Box Rack Cooler.....	131
35.3.	Adapter Brass.....	132
36.	COIL COMPLETE RACK COOLER.....	132
36.1.	Valve Flo-RGLTR	133
36.2.	Valve Core Refrigerant	133
36.3.	Valve Access Body.....	133
37.	HOSE KIT PACKAGING ASSEMBLY	134
38.	PANEL FAN RACKCOOLER	134
38.1.	Fan Axial.....	135
38.2.	Finger Guard	135
39.	Accessories.....	135

XD Field Installed Accessories..... 136

Model Number Designations

Model Number Breakdown / Liebert XDO XDO20BK--0

XD	O	20	B, D	K, S	—, P	—, E	0
Liebert	O = Overhead	= Model	B = Basic Unit	K=120V – 1ph-60Hz	- = Hard	- = Dom.	0 = Revision
Extreme Heat	Cooling Module	Size	D = Condensate	S=230V – 1ph-50Hz, CE,	Piped	Packaging	Level
Density			Detection	220-240V– 1ph-50/60Hz	P= Coupling	E= Exp.	
System						Packaging	

Model Number Breakdown / Liebert XDV XDV10BK--0

XD	V	10	B, D	K, S, T	—, P	—, E	0
Liebert	V = Vertical	= Model	B = Basic Unit	K = 120V - 1ph-60Hz	- = Hard Piped	- = Dom.	0 = Revision
Extreme Heat	Top Cooler	Size	D = Condensate	S = 230V – 1ph-50Hz,	P= Coupling	Packaging	Level
Density			Detection	CE		E= Exp.	
System				T = 208-240V– 1ph-60Hz, 220-240V-1ph-50Hz		Packaging	

Model Number Breakdown / Liebert XD CoolFrame XD-CF-10-BP-0

XD	CF	10	B, T	P	—, E	0
Liebert	CF = Module	= Model	B = Bottom Unit	P = Coupling	- = Dom.	0 = Revision Level
Extreme Heat	for BladeFrame	Size	T = Top Unit		Packaging	
Density	EX				E= Exp.	
System					Packaging	

Model Number Breakdown / Liebert XDH XDH20BK--0

XD	H	20	B, D	K, S, T	—, P	—, E	0
Liebert	H = Horizontal	= Model	B = Basic Unit	K=120V – 1ph-60Hz	- = Hard	- = Dom.	0 = Revision
Extreme Heat	Row Cooler	Size	D = Condensate		Piped	Packaging	Level
Density			Detection		P= Coupling	E= Exp.	
System						Packaging	

Model Number Breakdown / Liebert XDP XDP160RA--1

XD	P	160	R	A, C, M	—	—	1
Liebert	P = Pumping	= Model	R = Pump	C = 208V - 3ph-60Hz	- = Place	- = Place	1 = Revision
Extreme Heat	Unit	Size	Redundancy	A = 460V - 3ph-60Hz	Holder	Holder	Level
Density				M = 380/420V - 3ph-50Hz,			
System				CE			

Model Number Breakdown / Liebert XDC XDC160AA--0

XD	C	160	A	A, M	—	—	0
Liebert	C = Chiller	= Model	A = Place Holder	A = 460V - 3ph-60Hz	- = Place Holder	- = Place	0 = Revision
Extreme Heat		Size		M = 380/420V - 3ph-50Hz, CE		Holder	Level
Density							
System							

Model Number Breakdown / Liebert XDA XDA5BK--0

XD	A	5	B	K, T	—	—	0
Liebert	A = Air Flow	= Model	B = Basic Unit	K = 120V - 1ph-60Hz	- = Place	- = Place	0 = Revision
Extreme Heat	Enhancer	Size		T = 220-240V– 1ph-60Hz,	Holder	Holder	Level
Density				220-240V-1ph-50Hz			
System							

Model Number Breakdown / Liebert XDWR (RackCooler) RC08C-K0

RC	08	C	—	K, S	0
RackCooler	= Model Size	C = Chilled Water	- = Place Holder	K = 120 volt – 1 ph-60Hz	0 = Revision
				S = 230 volt – 1 ph-50/60Hz	Level

Model Number Breakdown / Liebert XDWP (Coolant Distribution Unit) CDU100C-A000

CDU	100	C	—	A, C, M	0	0	0
Coolant	= Model Size	C = Chilled	- = Place	A = 460 volt – 3 ph-60Hz	0 = Basic Unit	0 = Place	0 = Revision
Distribution		Water	Holder	C = 208 volt – 3 ph-60Hz		Holder	Level
Unit				M = 380/420V – 3 ph-50Hz, CE			

Product Description

Supplemental Zone and Spot Cooling (Pumped Refrigerant Based) - 60Hz

Increased Cooling Power for Rack Enclosures and High Heat Density Areas

Liebert X-treme Density heat removal system is designed to address the higher heat loads generated by densely populated electronic rack enclosures. It can cool more than 500 W per square foot. Individual modules can improve enclosure airflow or cool hot spots, or zones. The modules in the Liebert XD system use a unique heat rejection process, using a pumped refrigerant. It operates at low pressure and becomes a gas at room temperatures, making it ideal for use around electronic equipment. Liebert XD complement the precision cooling provided by Liebert Deluxe System/3 or Liebert DS, and are built with the quality and features you expect from Liebert.

Liebert XDO – Overhead Fan Coil: This ceiling-installed unit is placed above the heat-emitting equipment, drawing hot air from the Hot Aisle and discharging cold air down into the Cold Aisle. Uses pumped refrigerant technology.

Liebert XDV – Vertical Top Cooler: The XDV is installed above or on the rack enclosure. It draws in hot air from inside the enclosure or from the Hot Aisle. It then cools the air and discharges it down into the Cold Aisle. Uses pumped refrigerant technology.

Liebert XDP – Pumping Unit: When a building chilled water system is available, the XDP serves as an intermediary, to isolate the building chilled water circuit from the pump refrigerant circuit. It circulates the refrigerant to the XDV and XDO at a temperature always above the actual dew point to prevent condensation.

Liebert XDC – Refrigerant Chiller: The XDC is an indoor unit that connects directly to the XDO and XDV. It circulates the XD Coolant to the XDV and XDO at a temperature always above the actual dew point to prevent condensation.

Liebert XDA – Air Flow Enhancer: Lightweight fan unit is mounted to the exhaust side of a rack enclosure. The XDA, that is compatible with most rack enclosures, increases the airflow through densely populated enclosures, past congested cabling, thus removing hot spots within the enclosure that can threaten the uptime of critical systems.

Features

- Can Cool More Than 500 W/sqft
- Utilizes Pump Refrigerant Technology
- Energy Efficient
- Intelligent Controls of the Pump Refrigerant
- Floor Space Efficient
- Scalable and Flexible

Supplemental Zone and Spot Cooling (Water Based) - 60Hz

- **Environmental Control System**
- **Targets Enclosure Hot Spots Where They Occur**

The Liebert XDR (RackCooler) system has been engineered from the ground up as a supplemental cooling system designed to solve the specific problem of high heat loads in server enclosures. Liebert's XDR system utilizes a cooling module that is attached to the back door of the computer rack enclosure. Fans in the module move room temperature air from the front of the enclosure, past the equipment in the rack, past a cooling coil and expel it from the back of the unit, chilled to the point where the impact on the room is close to neutral. The XDR system can be configured to take care of uneven heat loads within the room. In other words, it can be placed to eliminate hot spots.

Liebert's XDR system consists of a number of cooling modules that are connected via quick-connect ports to a water pumping unit, XDWP. This coolant distribution unit controls coolant flow and acts as an interface with your building's chilled water system through a heat exchanger. It senses temperature and relative humidity inside the critical space and holds the water temperature in the XDR units above the room's dew point to prevent condensation on the coils.

Ideal Applications

- Colocation facilities
- Internet data centers
- Any computing or communications facility with high density of equipment

Features

- Minimal floor space requirements
- Easy to install
- Easy to connect
- Scalable
- Coolant distribution unit prevents condensation

Liebert XDA

1. XDA AIRMOVER ASSY

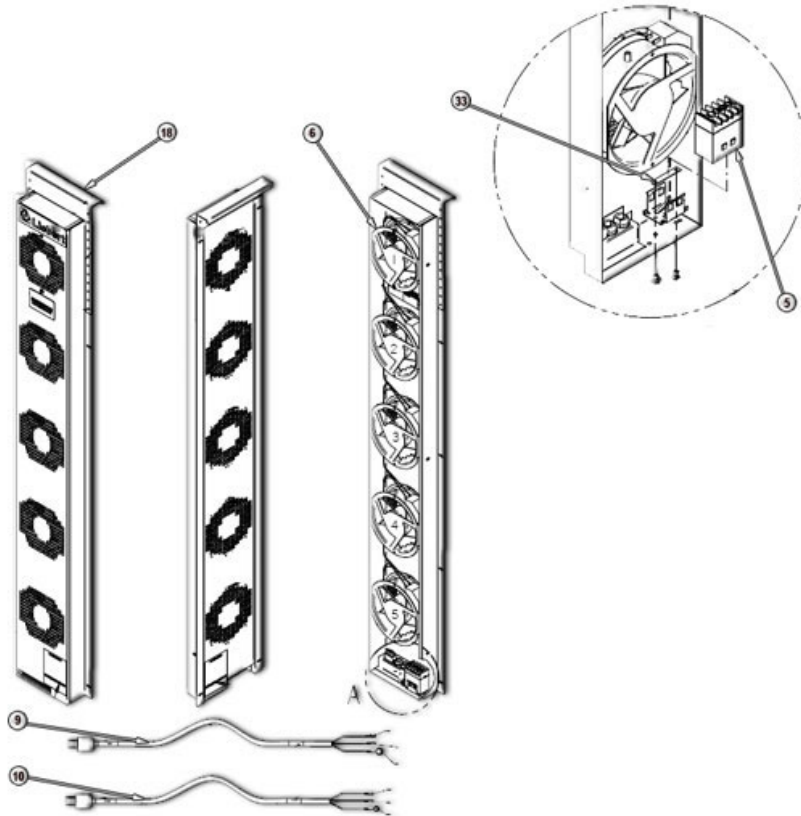

- | | | | |
|----|-------|-----|---------------|
| 5. | Relay | 10. | Cord |
| 6. | Fan | 18. | Bracket |
| 9. | Cord | 33. | Bracket Relay |

1.1. Relay



Part Number	Description	Quantity
180811P1	RELAY 4P 120V 2NO2NC	1
180811P2	RELAY 4P 230V 2NO/2NC	1

1.2. Fan



Part Number	Description	Quantity
5C10877P2	FAN 240CFM 220/230VAC 50/60HZ	5
5C10877P1	FAN 240CFM 115V	5

1.3. Cord



Part Number	Description	Volts	Quantity
177309G1	CORD PWR IEC 320 SJO W/TERMS	203V	1
177025G1	CORD PWR 18/3 SJO W/TERMS PRI	120V	1
177024G1	CORD PWR 18/3 SJO W/TERMS PRI	120V	1

1.4. Bracket



Part Number	Description	Quantity
176698P1	BRACKET SEC MOUNT AIRMOVER	1

1.5. Bracket Relay



Part Number	Description	Quantity
180849P1	BRACKET RELAY MTG OMRON G7J	1

Liebert XDV

2. XDV ASSEMBLY

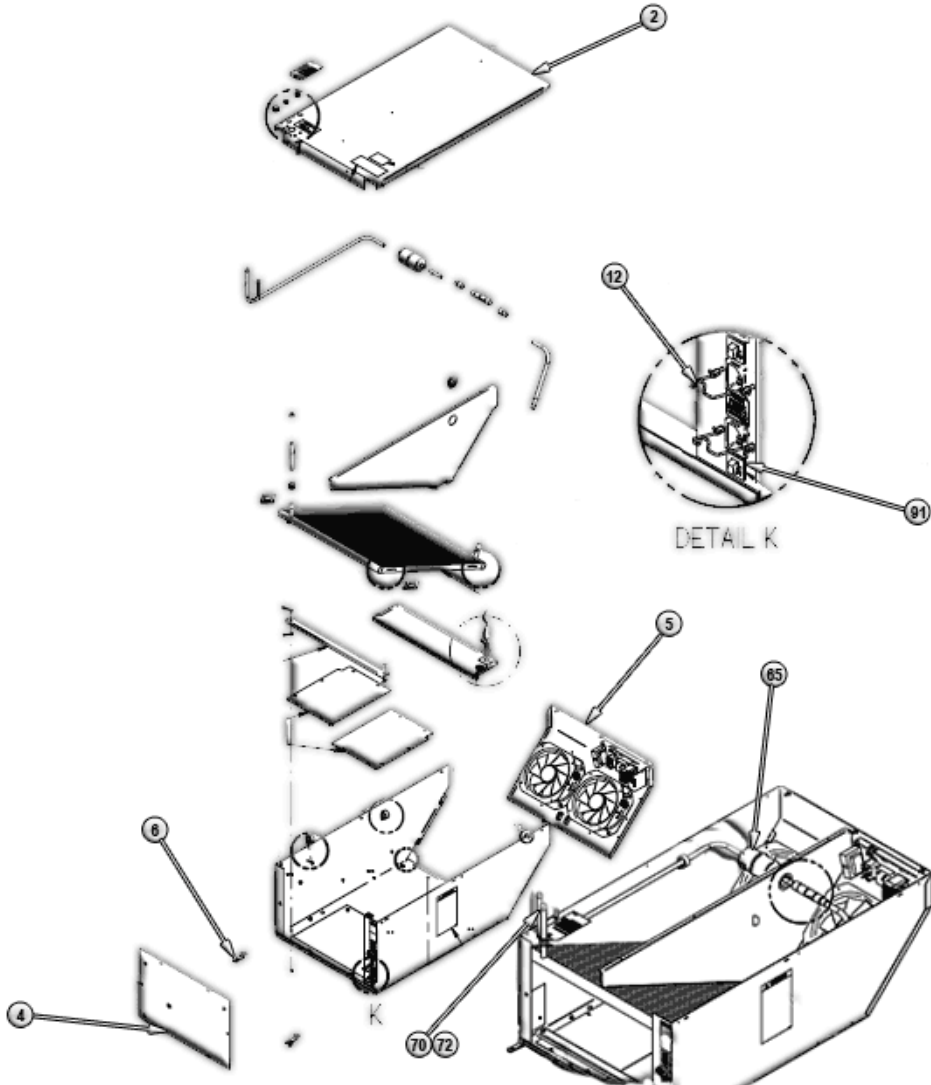

- | | | | |
|-----|-------------------------|-----|------------------------|
| 2. | Cover | 65. | Filter/Drier |
| 4. | Grille | 70. | Valve Access Body |
| 5. | Plate Fan Mounting | 72. | Valve Core Refrigerant |
| 6. | Bracket Mounting | 91. | Circuit Breaker |
| 12. | Cord Line Retainer Clip | | |

2.1. Cover

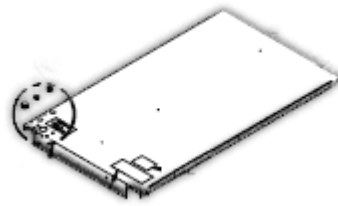

Part Number	Description	Quantity
177439P1	COVER XDV	1

2.2. Grille



Part Number	Description	Quantity
179185G1	GRILLE REAR INLET PAINTED XDV	1

2.3. Plate Fan Mounting

Part Number	Description	Quantity
177434G1	PLATE FAN MTG 120V ASSY XDV	1
177434G2	PLATE FAN MTG 230V ASY XDV8	1
177434G3	PLATE FAN MTG 120V ASY LQDXDV8	1
177434G4	PLATE FAN MTG 230V ASY LQDXDV8	1

2.4. Bracket Mounting



Part Number	Description	Quantity
177416P1	BRACKET XDV MTG 24"CABINET	2

2.5. Cord Line Retainer Clip



Part Number	Description	Quantity
179069P1	CORD LINE RETAINER CLIP 730-00	2

2.6. Filter/Drier



Part Number	Description	Quantity
178082P1	FILTER/DRIER 1/2" SOLDER	1

2.7. Valve Access Body



Part Number	Description	Quantity
P-3910	VALVE ACCESS BODY 1/4 EXT 2"	1

2.8. Valve Core Refrigerant



Part Number	Description	Quantity
P02-0290	VALVE CORE REFRIGERANT	1

2.9. Circuit Breaker



Part Number	Description	Quantity
179071P2	CB 3.0A PANEL MNT	2

3. Plate Mounting Assembly

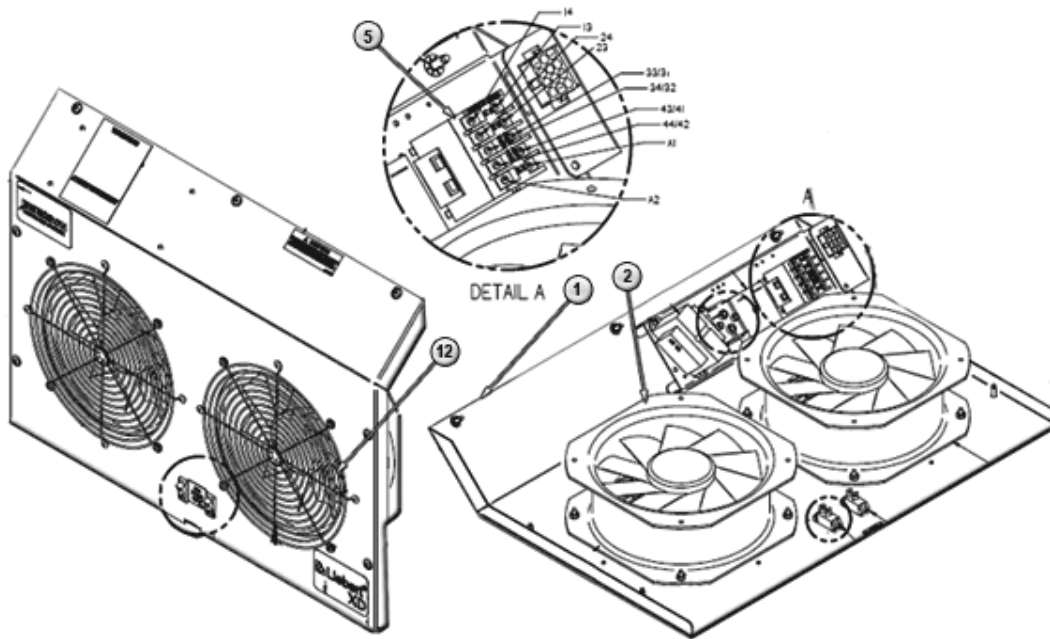

- 1. Plate Fan
- 2. Fan Motor
- 5. Relay
- 12. Guard Finger

3.1. Plate Fan

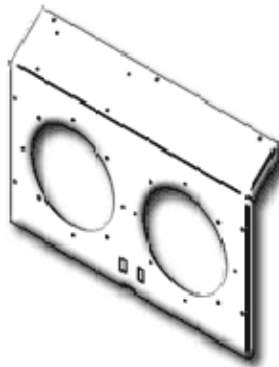

Part Number	Description	Quantity
177436P1	PLATE FAN MTG XDV	1

3.2. Fan Motor



Part Number	Description	Quantity
177625P1	FAN MOTOR 600 CFM 115 V 50/60	2
177625P2	FAN MOTOR 600 CFM 230V 50/60	2

3.3. Relay



Part Number	Description	Quantity
180811P1	RELAY 4P 120V 2NO/2NC	1
180811P2	RELAY 4P 230V 2NO/2NC	1

3.4. Guard Finger



Part Number	Description	Quantity
177415P1	GUARD FINGER 9" NOM FAN	2
177170G1	GUARD FINGER 9" NOM FAN BLACK	2

4. Accessories

Part Number	Description
180427G1	External Mounting Brackets Kits, for One XDV
180427G5	External Mounting Brackets Kits, for Five XDV
181400G1	Flexible Piping Kit, for One XDV, 6ft
181400G2	Flexible Piping Kit, for One XDV, 10ft

Liebert XDC

5. XDC EP ASSEMBLY

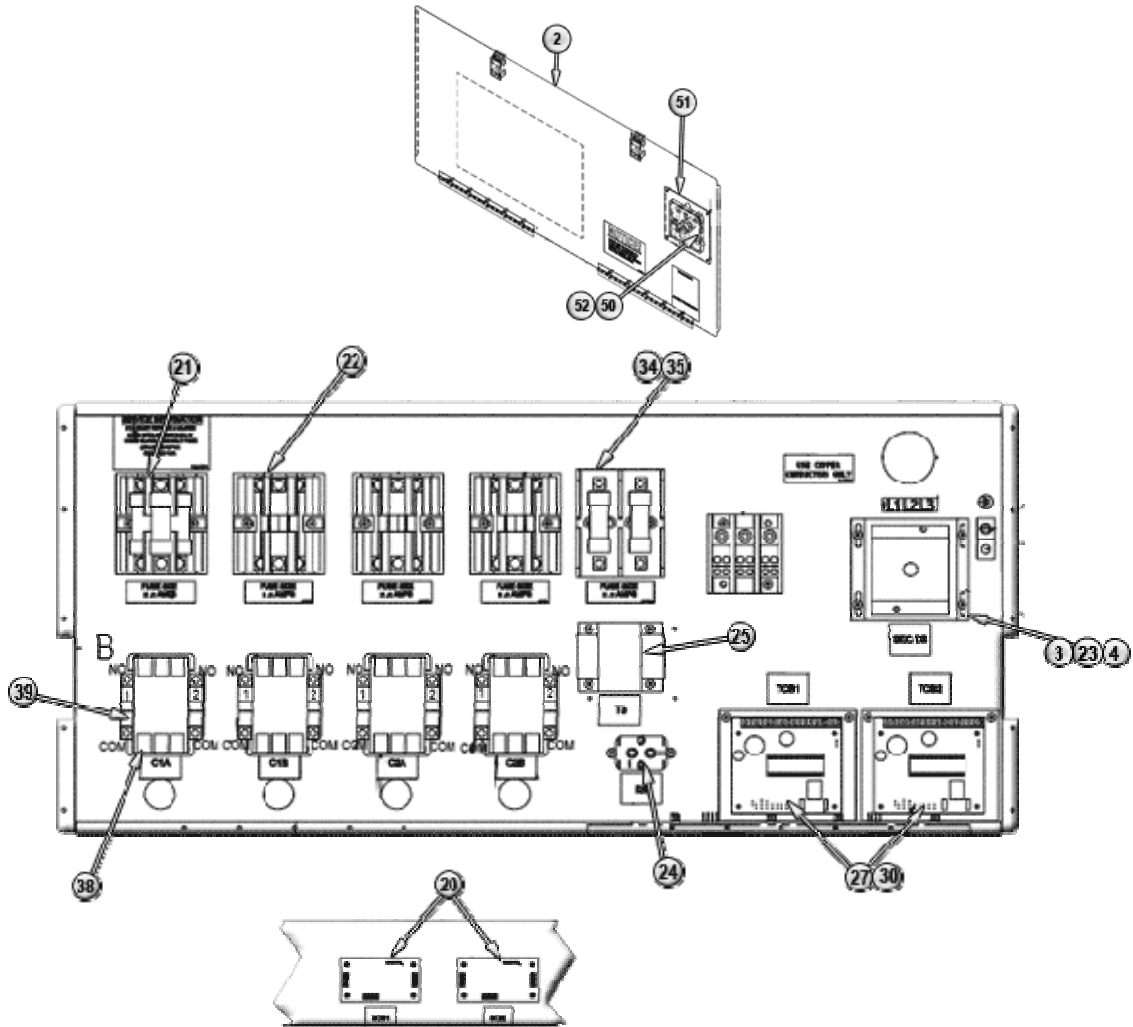

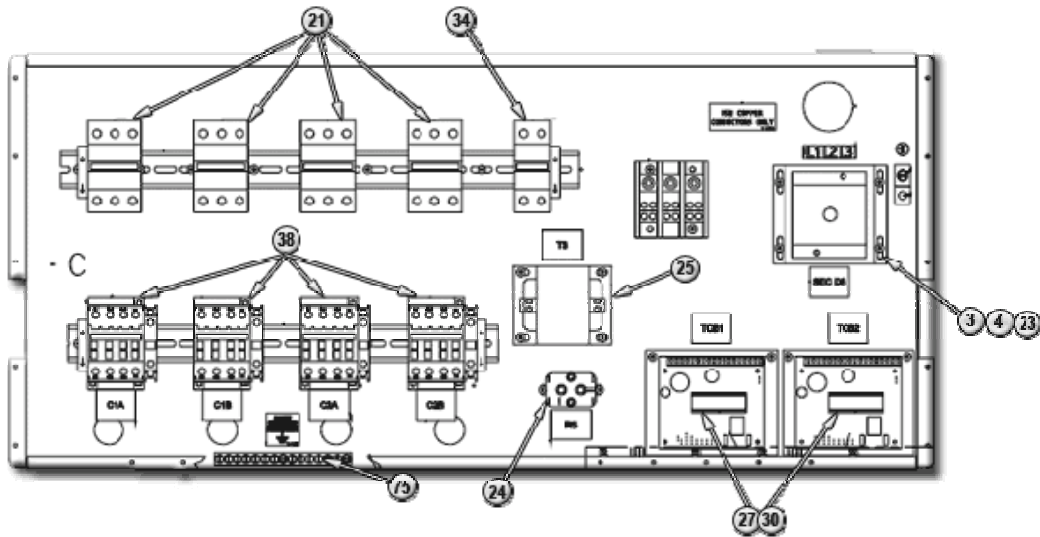

- | | | | |
|-----|---------------------|-----|-------------------|
| 2. | DeadFront XDC | 30. | Plate Back |
| 3. | Standoff Disconnect | 34. | FuseBlock |
| 4. | Collar | 35. | Fuse Dual Element |
| 20. | PWA Converter | 38. | Contactors |
| 21. | FuseBlock | 39. | Contacts |
| 22. | FuseBlock | 50. | Handle Disc |
| 23. | Switch Disconnect | 51. | Plate Disc |
| 24. | Relay | 52. | Label Disconnect |
| 25. | Transformer | 75. | Ground Lug |
| 27. | PWA Control | | |

5.1. DeadFront XDC

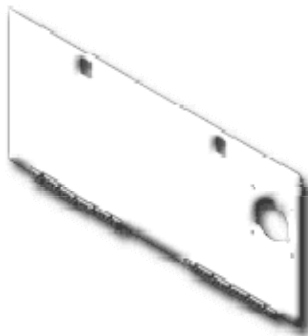

Part Number	Description	Quantity
179362P1	DEADFRONT XDC	1

5.2. Standoff Disconnect



Part Number	Description	Quantity
179810P1	STANDOFF DISCONNECT XDC/XDP	1

5.3. Collar



Part Number	Description	Quantity
1C18354P1	COLLAR LKG DISC W/2 SCREWS KM	1

5.4. PWA Converter



Part Number	Description	Quantity
4C14341G1	PWA MOD MTR 0-10V CONVTR	2

5.5. FuseBlock



Part Number	Description	Quantity
136811P1	FUSEBLOCK BUSS JP600V 30A 3P	4

5.6. FuseBlock

Part Number	Description	Quantity
136821P16	FUSE DUAL ELMNT "J" 600V 30.0A	12

5.7. Switch Disconnect

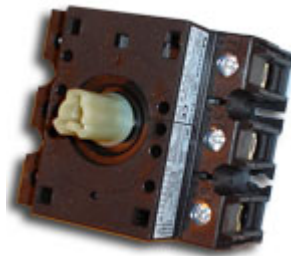

Part Number	Description	Quantity
1C18351P1	SW DISC 600V 3PL 100A	1

5.8. Relay



Part Number	Description	Quantity
E03-0170	RELAY 1P2T 24V 50/60HZ	1

5.9. Transformer



Part Number	Description	Quantity
E-007B	XFMR 075VA 60 460-24	1

5.10. PWA Control



Part Number	Description	Quantity
163587P2	PWA CNTRL ELEC HGBP FAST	2

5.11. Plate Back



Part Number	Description	Quantity
163589P1	PLATE BACK EHGBP	2

5.12. FuseBlock



Part Number	Description	Quantity
136810P1	FUSEBLOCK BUSS J 600V 30A 2P	1

5.13. Fuse Dual Element



Part Number	Description	Quantity
136821P2	FUSE DUAL ELMNT "J" 600V 1.25A	2

5.14. Contactor



Part Number	Description	Quantity
123273P1	CONTACTOR 3PL 25/30 NO/NC AUX	4

5.15. Contacts



Part Number	Description	Quantity
149117P1	CONTACTS AUX NO/NC 49ACR6 FRNS	4

5.16. Handle Disc



Part Number	Description	Quantity
1C18352P1	HANDLE DISC SWT/FACEPLATE K/M	1

5.17. Plate Disc



Part Number	Description	Quantity
1C18707P1	PLATE DISC K/M	1

5.18. Label Disconnect



Part Number	Description	Quantity
4D10624P1	LABEL DISCONNECT K/M LIEBERT	1

5.19. Ground Lug



Part Number	Description	Quantity
E-3620	GROUND LUG STRIP 13POS SCRTRM	1

6. EP XDC 460/480V 2 PUMP

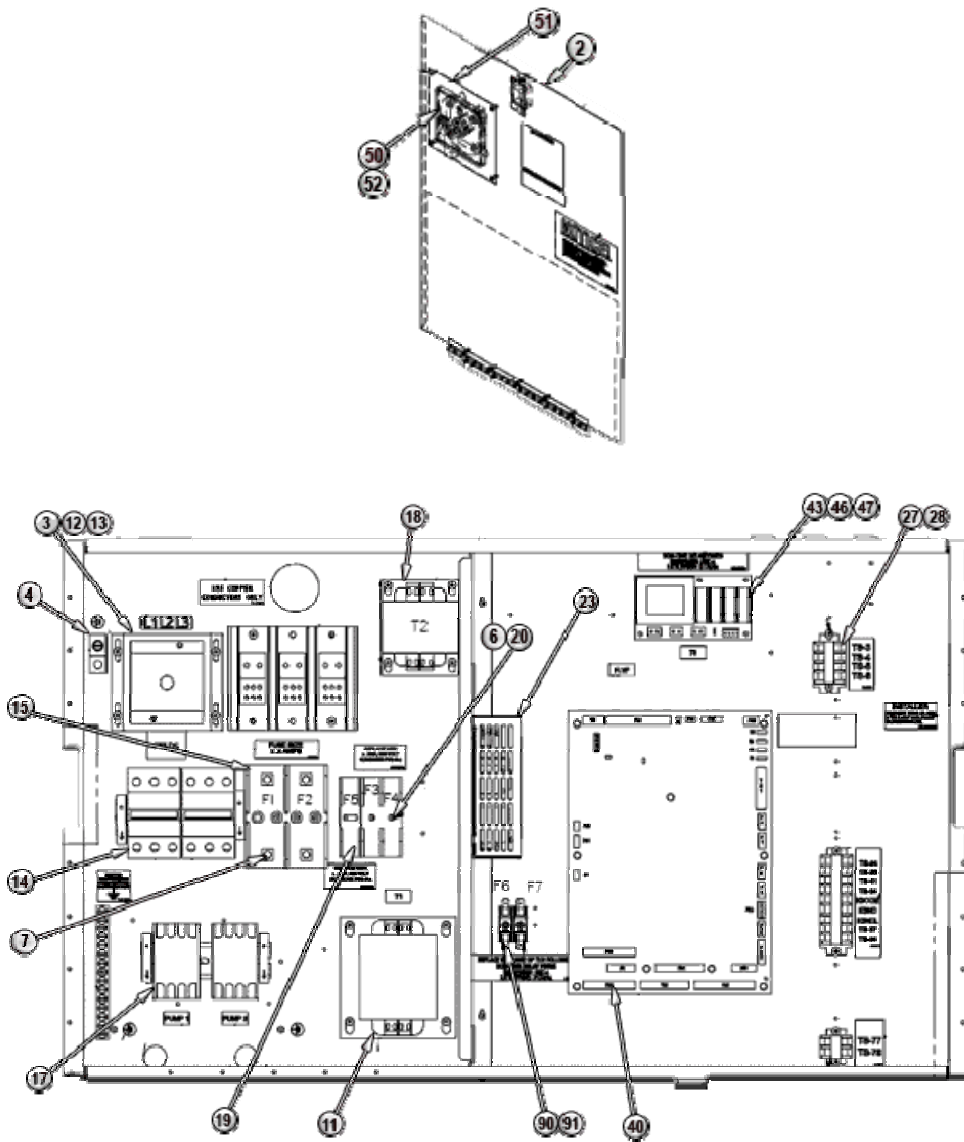

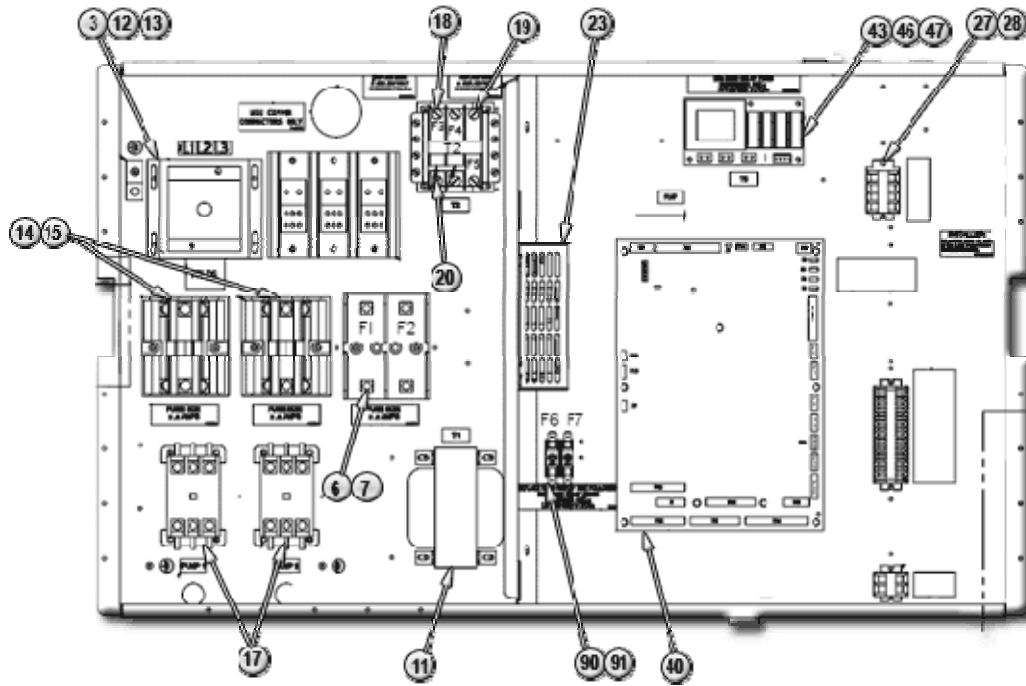

- | | | | |
|-----|---------------------------|-----|-----------------------|
| 2. | DeadFront XDC | 19. | Fuse |
| 3. | Collar Locking Disconnect | 20. | Fuse |
| 4. | Terminal Lug | 23. | Power Supply |
| 6. | FuseBlock Buss | 27. | Terminal Strip |
| 7. | FuseBlock | 28. | Terminal Strip End |
| 11. | Transformer | 40. | PWA Universal Control |
| 12. | Standoff Disconnect | 43. | PWA ISO XFMR/Fuse |
| 13. | Switch Disconnect | 46. | Fuse Kit |
| 14. | Fuse Dual Element | 47. | Fuse Glass |
| 15. | FuseBlock | 90. | Fuse Glass |
| 17. | Contactor | 91. | FuseBlock |
| 18. | Transformer | | |

6.1. DeadFront XDC

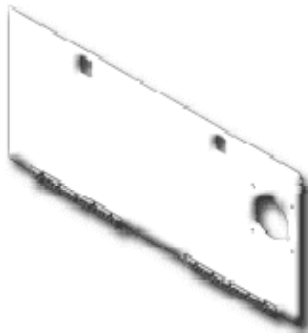

Part Number	Description	Quantity
179362P1	DEADFRONT XDC	1

6.2. Collar Locking Disconnect



Part Number	Description	Quantity
1C18354P1	COLLAR LKG DISC W/2 SCREWS KM	1

6.3. Terminal Lug



Part Number	Description	Quantity
E-362B	TERM LUG MECH #14-2/0 1/4"	1

6.4. FuseBlock Buss



Part Number	Description	Quantity
136810P1	FUSEBLOCK BUSS J 600V 30A 2P	1

6.5. FuseBlock



Part Number	Description	Quantity
1C13244P1	FUSEBLOCK 600V 2P 030A	1

6.6. Transformer



Part Number	Description	Quantity
136202P1	XFMR 300VA 460-615/2460	1

6.7. Standoff Disconnect



Part Number	Description	Quantity
179810P1	STANDOFF DISCONNECT XDC/XDP	1

6.8. Switch Disconnect



Part Number	Description	Quantity
1C18351P1	SW DISC 600V 3PL 100A	1

6.9. Fuse Dual Element



Part Number	Description	Quantity
136821P10	FUSE DUAL ELMNT "J" 600V 10.0A	6

6.10. Fuseblock



Part Number	Description	Quantity
136811P1	FUSEBLOCK BUSS JP600V 30A 3P	2

6.11. Contactor



Part Number	Description	Quantity
124501P1	CONTACTOR 3PL 24VCOIL 15/20AMP	2

6.12. Transformer



Part Number	Description	Quantity
519458P1	XFMR 100VA 480-240/120 W/FUSE	1

6.13. Fuse



Part Number	Description	Quantity
127977P7	FUSE FNQ-R-1/2	2

6.14. Fuse



Part Number	Description	Quantity
127977P2	FUSE FNQ-R-1/4	4

6.15. Power Supply



Part Number	Description	Quantity
140922P1	PWR SPLY UNIV 1.6A 24VDC	1

6.16. Terminal Strip



Part Number	Description	Quantity
132487P1	TERMLSTRIP SECTION 1 POS	15

6.17. Terminal Strip End



Part Number	Description	Quantity
132487P2	TERMLSTRIP SECTION END BARRIER	3

6.18. PWA Universal Control



Part Number	Description	Quantity
415761G7	PWA UNIVERSAL CONTROL XDC	1

6.19. PWA ISO XFMR/Fuse



Part Number	Description	Quantity
4C14651G1	PWA ISO XFMR/FUSE INTF	1

6.20. Fuse Kit



Part Number	Description	Quantity
135637P2	FUSE KIT Quantity 8 4A NON-TD FUSES	1

6.21. Fuse Glass



Part Number	Description	Quantity
135409P2	FUSE GLASS 250V 4AMP .25X1.25	4

6.22. Fuse Glass



Part Number	Description	Quantity
135409P4	FUSE GLASS 250V 4AMP .25X1.25	4

6.23. FuseBlock



Part Number	Description	Quantity
176023P1	FUSEBLOCK 1P 300V	2

7. DSCH STACK GRUNDFOS

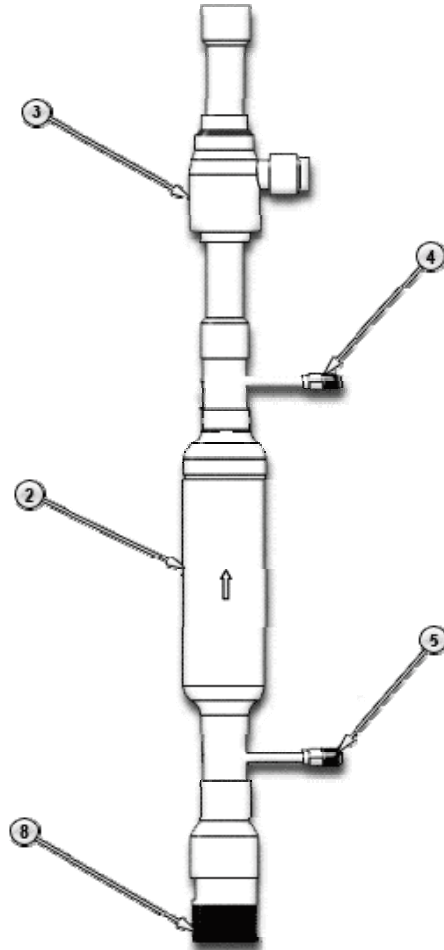

- | | |
|----------------------|---------------------------|
| 2. Valve Check | 5. Valve Core Refrigerant |
| 3. Valve Ball | 8. Adapter |
| 4. Valve Access Body | |

7.1. Valve Check



Part Number	Description	Quantity
1C23493P1	VALVE CHECK 1-1/8" OD	1

7.2. Valve Ball



Part Number	Description	Quantity
1A25919P1	VALVE BALL REFRIG 1-1/8"	1

7.3. Valve Access Body



Part Number	Description	Quantity
P-3910	VALVE ACCESS BODY 1/4 EXT 2"	2

7.4. Valve Core Refrigerant



Part Number	Description	Quantity
P02-0290	VALVE CORE REFRIGERANT	2

7.5. Adapter



Part Number	Description	Quantity
180328P1	ADAPTER ST/CU 1-5/8FTGX1-1/4M	1

8. Piping Configuration

8.1. Compressors

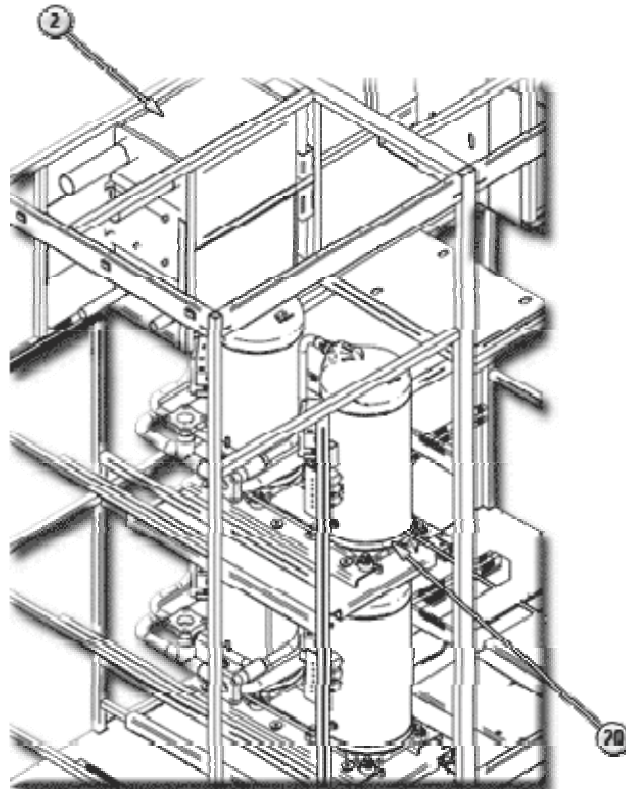

- 2. HX CSCDE Condenser
- 20. XDC Compressor Mount

8.1.1. HX CSCDE Condenser



Part Number	Description	Quantity
179288G1	HX CSCDE COND ASSY XDC	1

8.1.2. XDC Compressor Mount

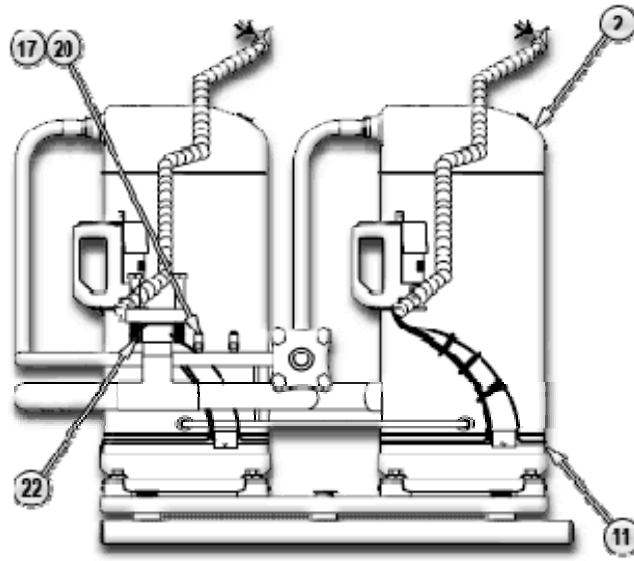

- 2. Compressor Scroll
- 11. Crankcase Heater
- 17. Valve Access Body
- 20. Valve Core Refrigerant
- 22. Gasket Valve

Compressor Scroll

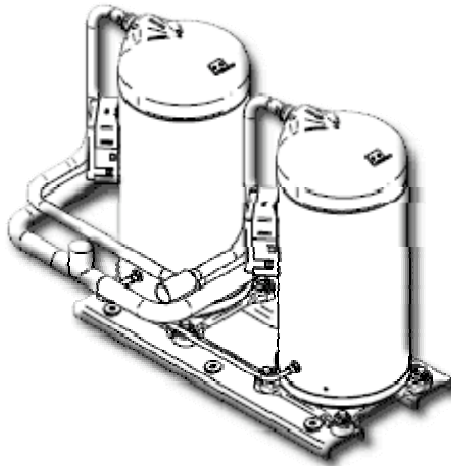

Part Number	Description	Quantity
179303P1	COMP SCRL ZRT250KCE-TFD	2

Crankcase Heater



Part Number	Description	Quantity
172147P2	HEATER C/CASE 480V 90W SMT SCR	4

Valve Access Body



Part Number	Description	Quantity
P02-0270	VALVE ACCESS BODY 1/4X SWT	4

Valve Core Refrigerant



Part Number	Description	Quantity
P02-0290	VALVE CORE REFRIGERANT	4

Gasket Valve



Part Number	Description	Quantity
C-089A	GASKET VALVE COMP SERVICE	4

8.2. Suction Lines

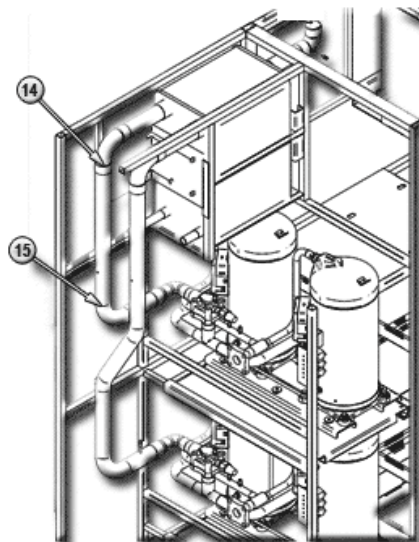

- 14. XDC Suction Circuit
- 15. XDC Suction Circuit 2

8.2.1 XDC Suction Circuit

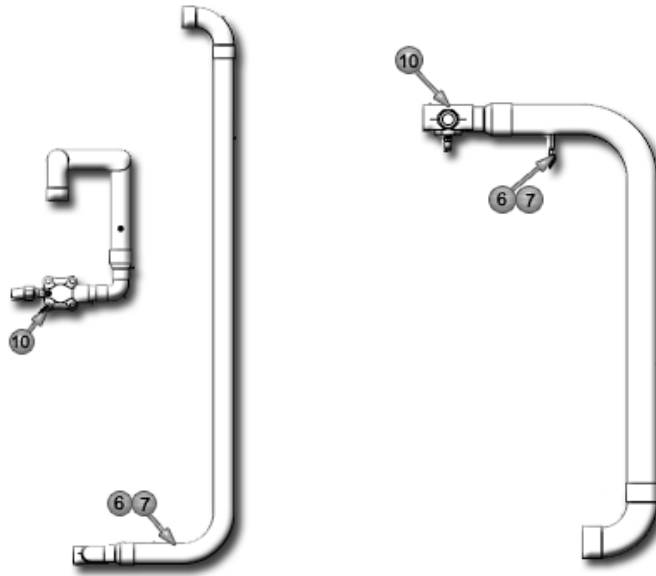

- 6. Valve Access Body
- 7. Valve Core Refrigerant
- 10. Valve Comp Serv

8.2.1.1 Valve Access Body



Part Number	Description	Quantity
P-3910	VALVE ACCESS BODY 1/4 EXT 2"	1

8.2.1.2 Valve Core Refrigerant



Part Number	Description	Quantity
P02-0290	VALVE CORE REFRIGERANT	1

8.2.1.3 Valve Comp Serv



Part Number	Description	Quantity
130740P1	VALVE COMP SERV SUCT 1-5/8SWT	1

8.3. Discharge Lines

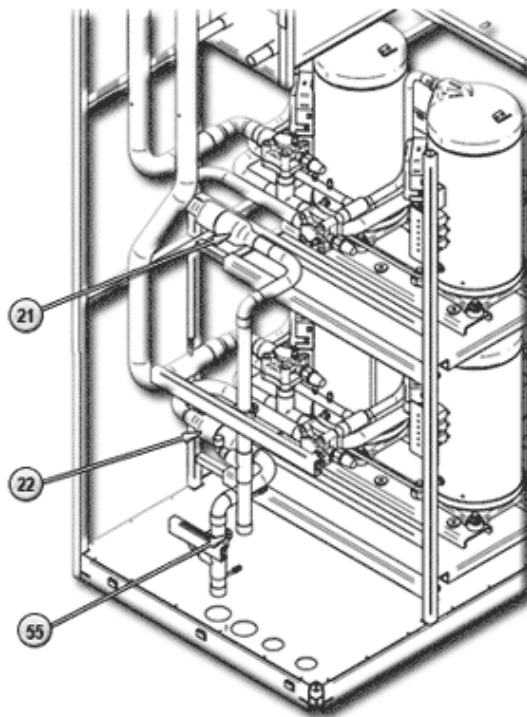

- 21. XDC Comp1 Discharge
- 22. XDC Comp2 Discharge
- 55. Clamp Tube

8.3.1 XDC Comp1/ Comp2 Discharge

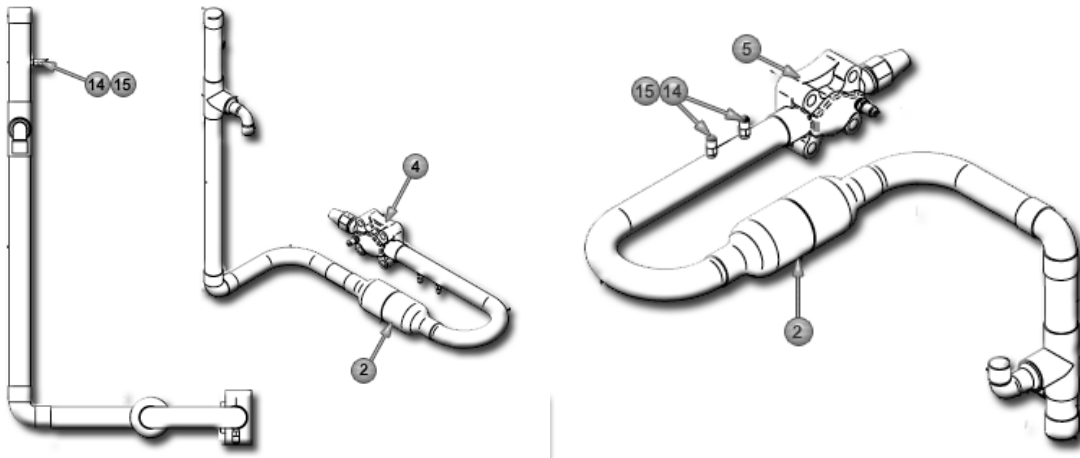

- 2. Check Valve
- 4./5. Valve Comp Serv
- 14. Valve Access Body
- 15. Valve Core Refrigerant

8.3.1.1 Check Valve



Part Number	Description	Quantity
179306P1	CHECK VLV 1-3/8" SWT	1

8.3.1.2 Valve Comp Serv



Part Number	Description	Quantity
1A18898P1	VALVE COMP SERV 1-3/8ID	1

8.3.1.3 Valve Access Body



Part Number	Description	Quantity
P-3910	VALVE ACCESS BODY 1/4 EXT 2"	1

8.3.1.4 Valve Core Refrigerant



Part Number	Description	Quantity
P02-0290	VALVE CORE REFRIGERANT	1

8.3.3 Clamp Tube



Part Number	Description	Quantity
179061P4	CLAMP TUBE CUSH-A-CLAMP 1.375	2

8.4. HGBP and Liquid Return Lines

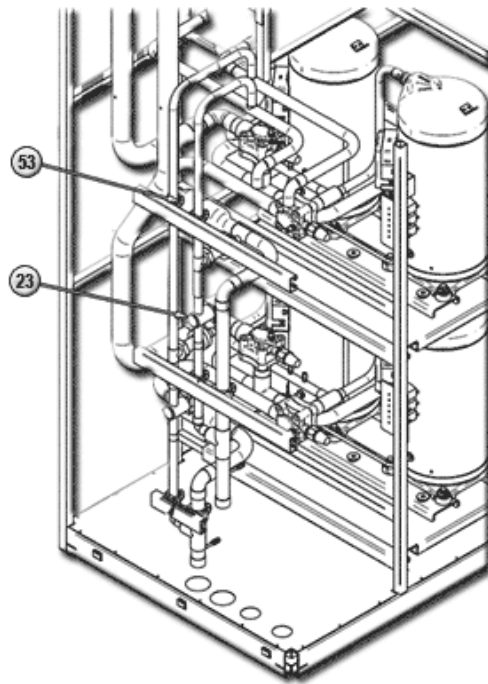

23. XDC HGBP

53. Clamp Tube

8.4.1 XDC HGBP Assembly

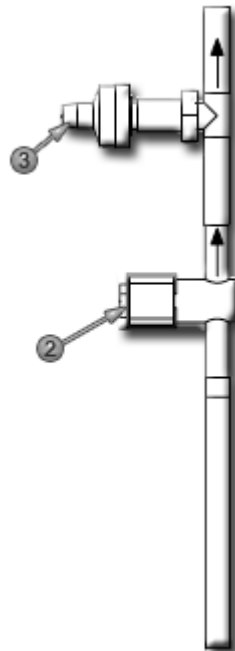

2. Valve Solenoid

3. Valve Electronic HGBP

8.4.1.1 Valve Solenoid



Part Number	Description	Quantity
P-287A	VALVE SOLND 7/8FXM 24V-50/60	1

8.4.1.2 Valve Electronic HGBP



Part Number	Description	Quantity
163586P2	VALVE ELECTRONIC HGBP	1

8.4.2 Clamp Tube



Part Number	Description	Quantity
179061P5	CLAMP TUBE CUSH-A-CLAMP 0.875	5

8.5. Liquid Return Stacks and Clamps

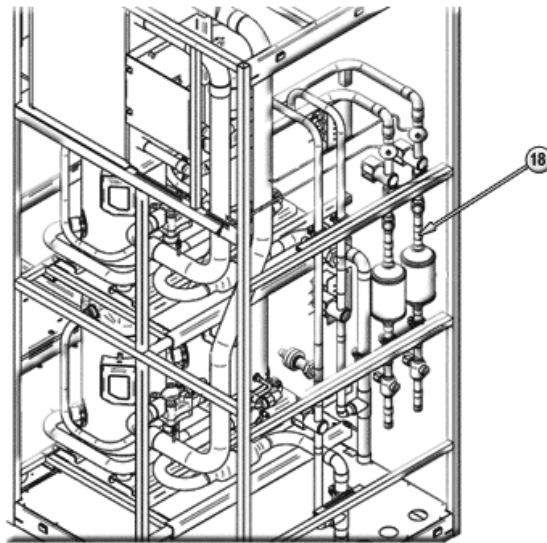

18. XDC Liquid Line

8.5.1 XDC Liquid Line

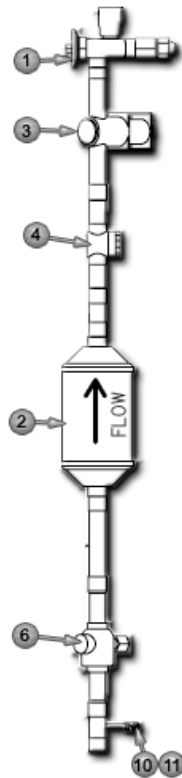

- | | |
|---------------------|----------------------------|
| 1. Valve Exp | 6. Valve Ball Refrigerant |
| 2. Filter/Drier | 10. Valve Access Body |
| 3. Solenoid | 11. Valve Core Refrigerant |
| 4. Liquid Indicator | |

8.5.1.1 Valve Exp



Part Number	Description	Quantity
133532P1	VALVE EXP 7/8X1-1/8X1/4ODF 60"	1

8.5.1.2 Filter/Drier



Part Number	Description	Quantity
130721P1	FILTER/DRIER 7/8ODF SLDR	1

8.5.1.3 Valve Solenoid



Part Number	Description	Quantity
P-287A	VALVE SOLND 7/8FXM 24V-50/60	1

8.5.1.4 Liquid Indicator



Part Number	Description	Quantity
P05-1050	INDICATOR LIQUID 7/8"ODF	1

8.5.1.5 Valve Ball Refrigerant



Part Number	Description	Quantity
P05-1380	VALVE BALL REFRIG 7/8"	1

8.5.1.6 Valve Access Body



Part Number	Description	Quantity
P-3910	VALVE ACCESS BODY 1/4 EXT 2"	1

8.5.1.7 Valve Core Refrigerant



Part Number	Description	Quantity
P02-0290	VALVE CORE REFRIGERANT	1

8.6. Pumps and Receiver

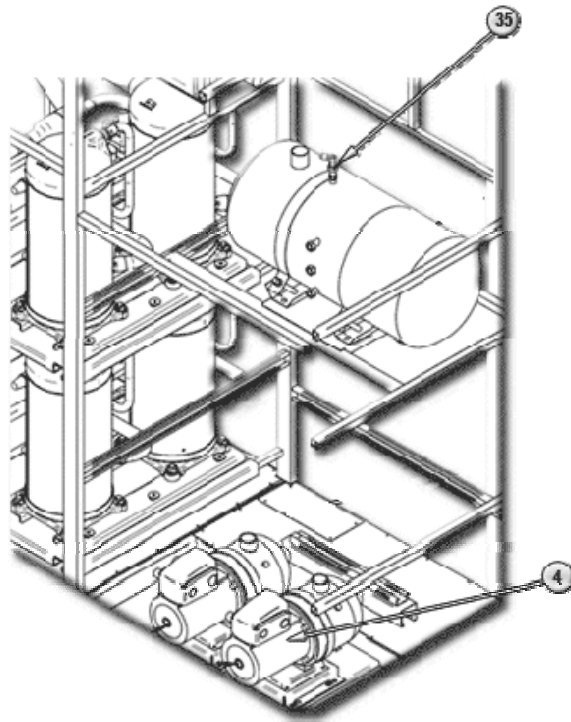

- 4. Pump
- 35. Valve Relief

8.6.1 Pump



Part Number	Description	Quantity
183404G1S	KIT PUMP REPLACEMENT 208V XD	2
183404G2S	KIT PUMP REPLACEMENT 460V XD	2
183404G3S	KIT PUMP REPLACEMENT 400V XD	2

8.6.2 Valve Relief



Part Number	Description	Quantity
178753P1	VALVE RELIEF 300#1/4MPTX3/8FLR	1

8.7. Pumps Suction Lines

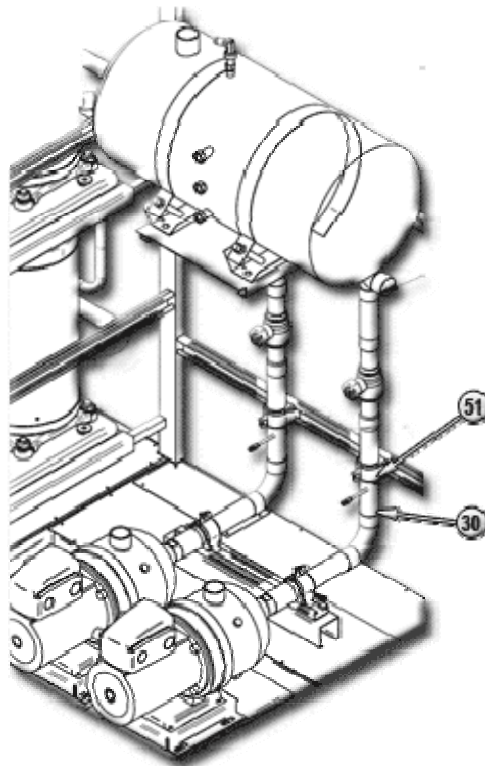

- 30. Suction Line
- 51. Clamp Tube

8.7.1 Suction Line

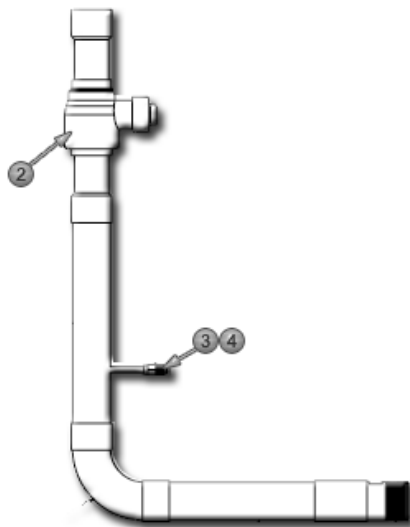

- 2. Valve Ball Refrigerant
- 3. Valve Access Body
- 4. Valve Core Refrigerant

8.7.1.1 Valve Ball Refrigerant



Part Number	Description	Quantity
177813P1	VALVE BALL REFRIG 1-5/8"	1

8.7.1.2 Valve Access Body



Part Number	Description	Quantity
P-3910	VALVE ACCESS BODY 1/4 EXT 2"	1

8.7.1.3 Valve Core Refrigerant



Part Number	Description	Quantity
P02-0290	VALVE CORE REFRIGERANT	1

8.7.2 Clamp Tube



Part Number	Description	Quantity
179061P1	CLAMP TUBE CUSH-A-CLAMP 1.625	5

9. Filter/Drier Replace Assembly

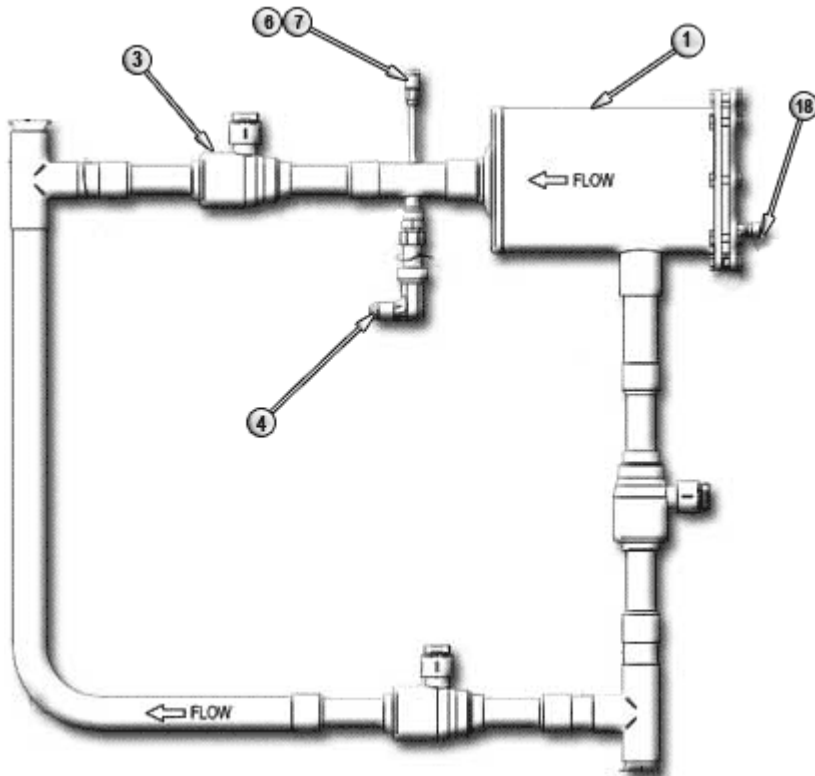

- | | |
|-----------------|---------------------------|
| 1. Filter Drier | 6. Valve Access Body |
| 3. Valve Ball | 7. Valve Core Refrigerant |
| 4. Valve Relief | 18. Valve Access |

9.1. Filter Drier



Part Number	Description	Quantity
1A21683P4	FILTER DRIER REPL C489 1.1 ODF	1

9.2. Valve Ball



Part Number	Description	Quantity
1A25919P1	VALVE BALL REFRIG 1-1/8"	3

9.3. Valve Relief



Part Number	Description	Quantity
178753P1	VALVE RELIEF 300#1/4MPTX3/8FLR	1

9.4. Valve Access Body



Part Number	Description	Quantity
P-3910	VALVE ACCESS BODY 1/4 EXT 2"	1

9.5. Valve Access



Part Number	Description	Quantity
175817P1	VALVE ACCESS BODY ONLY 1/4"NPT	1

9.6. Valve Core Refrigerant



Part Number	Description	Quantity
P02-0290	VALVE CORE REFRIGERANT	1

10. Press Switch Assembly

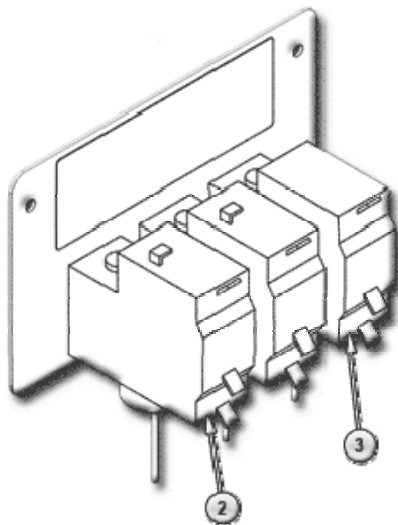

2/3. Pressure Switch

10.1. Pressure Switch



Part Number	Description	Quantity
1D15060P1	SW PRES HI 360PSI	1

10.2. Pressure Switch



Part Number	Description	Quantity
1D16206P1	SW PRES LOW 20/65PSI	2

11. Accessories

Part Number	Description
CSL415	Condenser
CSL616	Condenser
185010G2	Receiver Kit
185010G4	Receiver Kit
179713G1	Receiver Kit
179713G3	Receiver Kit
179711G1	Head Pressure Kit
179711G2	Head Pressure Kit

Liebert XDO

12. XDO16 w/ COND Detection

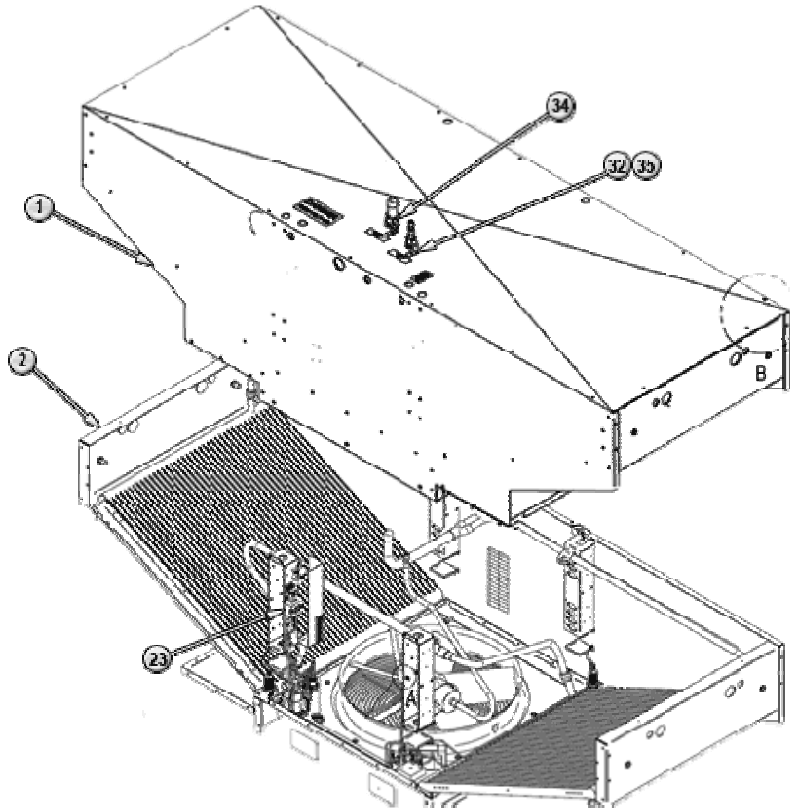

- 1. Panel
- 2. End Panel
- 23. PowerBlock
- 32. Angle Evap Coil
- 34. Clamp Insulated Metal
- 35. Clamp Insulated Metal

12.1. Panel



Part Number	Description	Quantity
179412P1	PANEL FR/RR EXT	2

12.2. End Panel

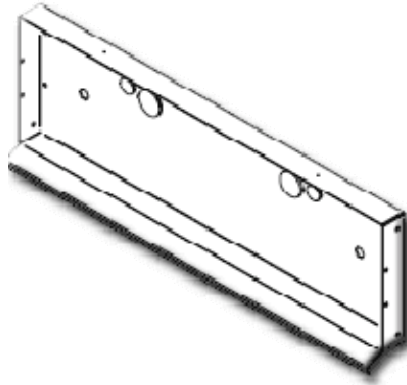

Part Number	Description	Quantity
179406P1	END PANEL	2

12.3. PowerBlock



Part Number	Description	Quantity
136205P1	PWRBLK 2PL 600V 65A TCHPRF	2

12.4. Angle Evap Coil



Part Number	Description	Quantity
139513P1	ANGLE EVAP COIL 20GA GALV ST	2

12.5. Clamp Insulated Metal



Part Number	Description	Quantity
P-3820	CLAMP INSULATED METAL 7/8"	1

12.6. Clamp Insulated Metal



Part Number	Description	Quantity
P-2290	CLAMP INSULATED METAL 1/2"	1

13. XDO Unit Assembly 208V

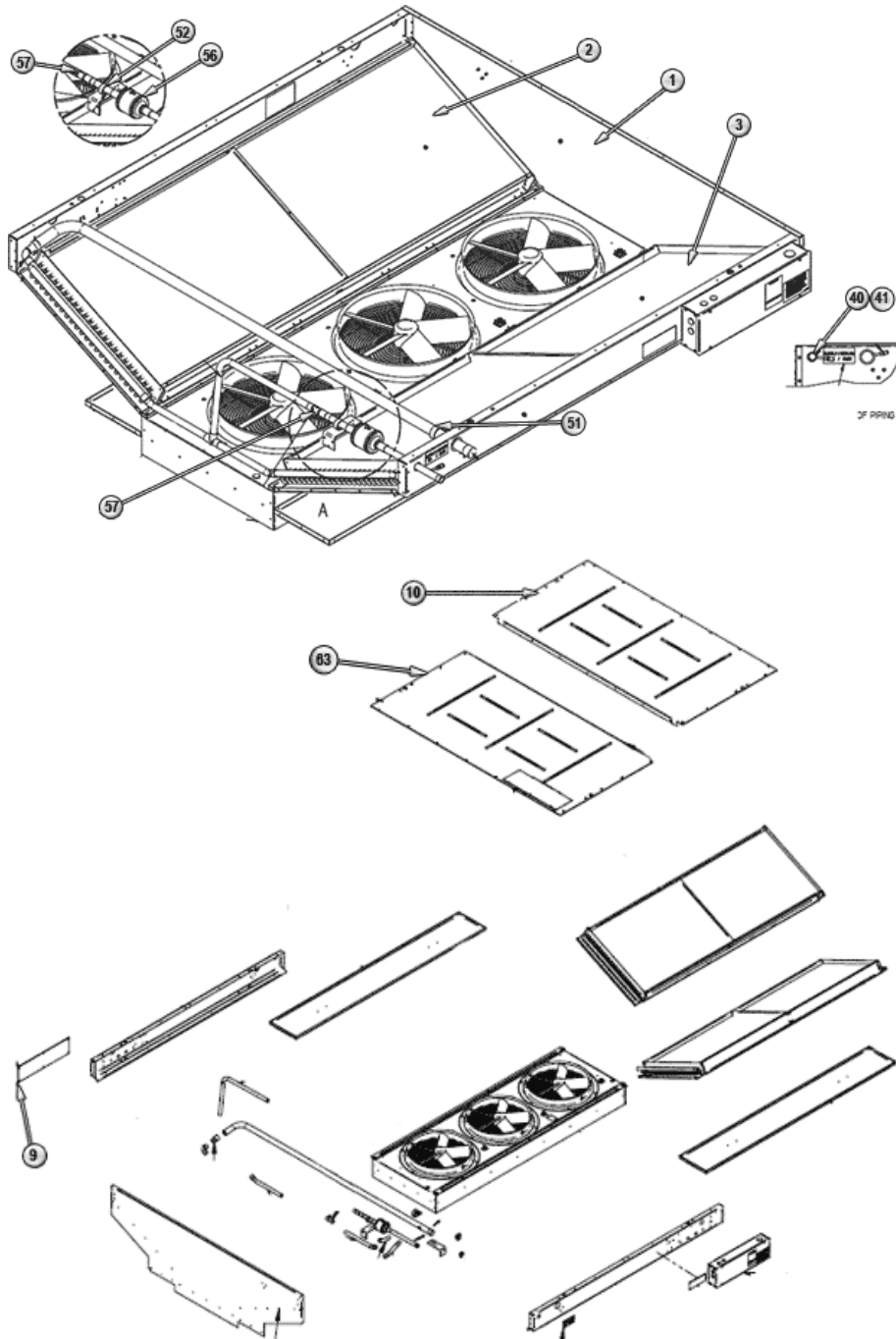

- | | | | |
|-----|-------------------|--------|------------------------|
| 1. | Panel | 41. | Valve Core Refrigerant |
| 2. | Coil Assy Left | 51/52. | Clamp Insulated Metal |
| 3. | Coil Assy Right | 56. | Filter/Drier |
| 9. | Plate Cover | 57. | Regulator |
| 10. | Panel Top Rear | 63. | Panel Top Front |
| 40. | Valve Access Body | | |

13.1. Panel



Part Number	Description	Quantity
176200P1	PANEL FR/RR EXT XDO	2

13.2. Coil Assy Left

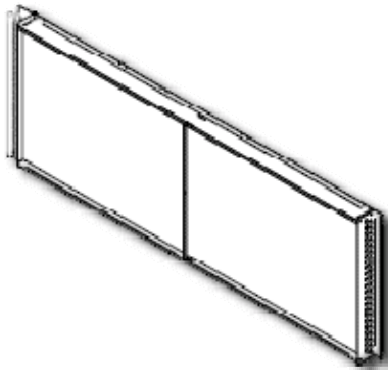

Part Number	Description	Quantity
176201G1	COIL ASSY XDO L	1

13.3. Coil Assy Right

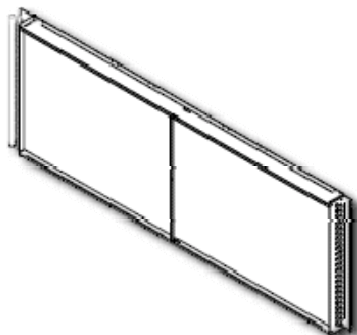

Part Number	Description	Quantity
176201G2	COIL ASSY XDO R	1

13.4. Plate Cover

Part Number	Description	Quantity
176212P1	PLATE COVER XDO	1

13.5. Panel Top Rear

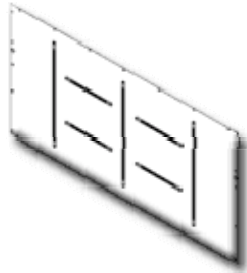

Part Number	Description	Quantity
176217P1	PANEL TOP XDO REAR	1

13.6. Valve Access Body



Part Number	Description	Quantity
P-391B	VALVE ACCESS BODY 1/4 EXT 1"	2

13.7. Valve Core Refrigerant



Part Number	Description	Quantity
P02-0290	VALVE CORE REFRIGERANT	2

13.8. Clamp Insulated Metal



Part Number	Description	Quantity
P-5010	CLAMP INSUL MTL HVY DTY 1-3/8"	1

13.9. Filter/Drier



Part Number	Description	Quantity
178082P2	FILTER/DRIER 7/8" SOLDER	1

13.10. Regulator



Part Number	Description	Quantity
178083P2	REGULATOR CONSTANT FLOW 3.5"	1

13.11. Panel Top Front

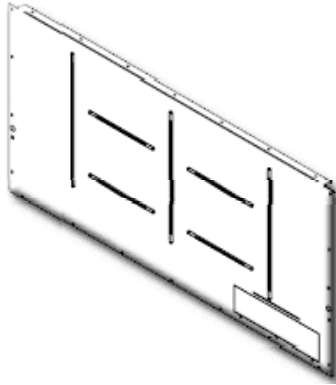

Part Number	Description	Quantity
176217P2	PANEL TOP XDO FRONT	1

14. BOX ELEC ASSY 208V XDO

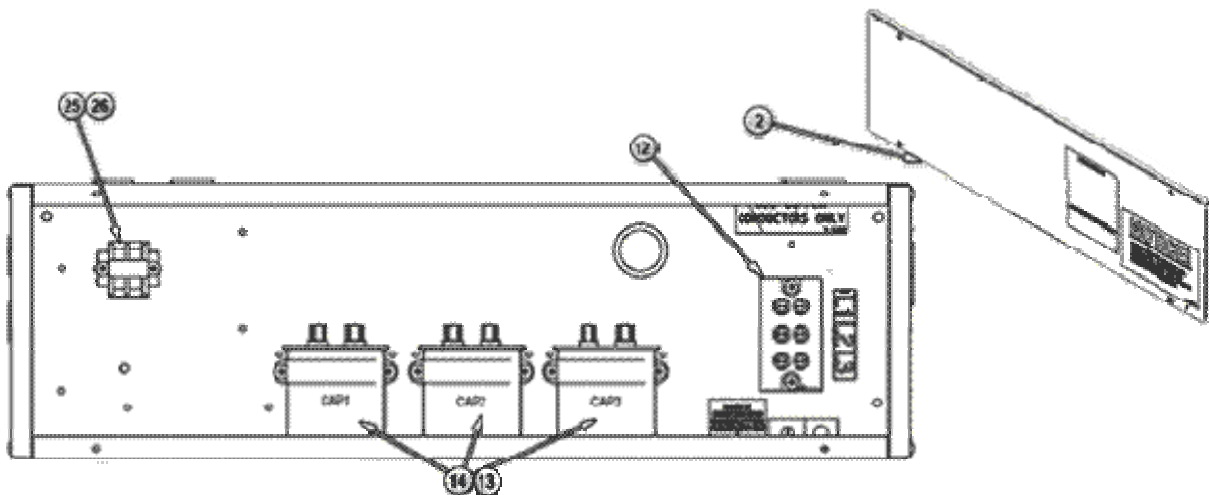

- | | |
|-------------------|--------------------|
| 2. Cover Elec Box | 14. Capacitor |
| 12. PowerBlock | 25. Terminal Strip |
| 13. Bracket Cap | 26. Terminal Strip |

14.1. Cover Elec Box

Part Number	Description	Quantity
176204P1	COVER ELEC BOX XDO	1

14.2. PowerBlock



Part Number	Description	Quantity
136205P1	PWRBLK 2PL 600V 65A TCHPRF	2

14.3. Bracket Cap



Part Number	Description	Quantity
B15-0120	BRKT CAP MTG 1.75" DIA	3

14.4. Capacitor



Part Number	Description	Quantity
C03-005A	CAP RUN 25UF 370VAC	3

14.5. Terminal Strip



Part Number	Description	Quantity
132487P1	TERMLSTRIP SECTION 1 POS	2

14.6. Terminal Strip



Part Number	Description	Quantity
132487P2	TERMLSTRIP SECTION END BARRIER	1

15. TRAY FAN ASSY W/ LIQUID SENSOR 230V

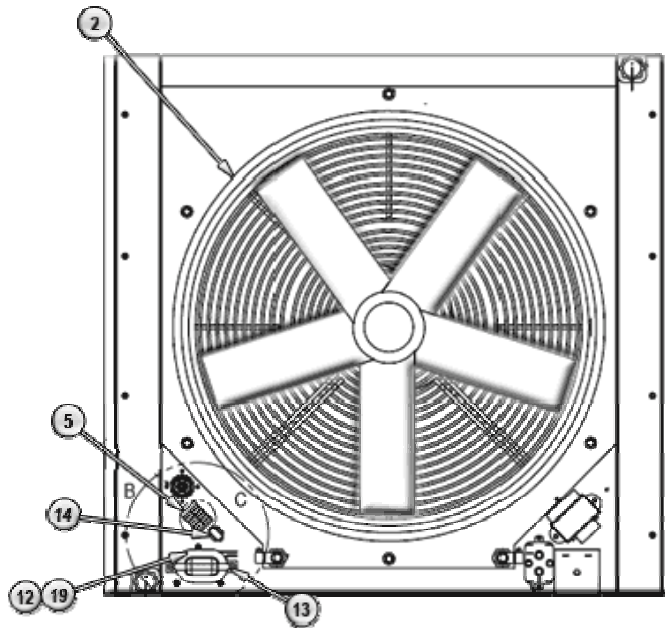

- | | |
|------------------|---------------------|
| 2. Fan Axial | 13. Bracket Cap |
| 5. Switch Rocker | 14. Circuit Breaker |
| 12. Capacitor | 19. Boot Cap |

15.1. Fan Axial



Part Number	Description	Quantity
171837G4L	FAN ASSY 230V XD016	1
171837G6L	FAN ASSY 230V XD016	1

15.2. Switch Rocker

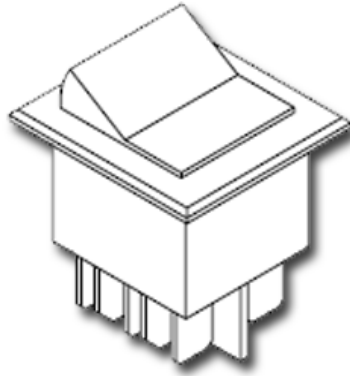

Part Number	Description	Quantity
179429P1	SWITCH ROCKER DPDT CENTER OFF	1

15.3. Capacitor

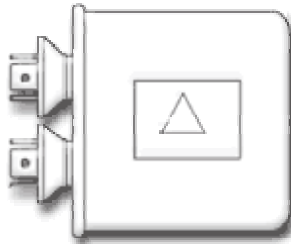

Part Number	Description	Quantity
127186P1	CAP RUN 25UF 370VAC	1

15.4. Bracket Cap



Part Number	Description	Quantity
127167P1	BRKT CAP MTG 1X20VL W/FT	1

15.5. Circuit Breaker



Part Number	Description	Quantity
179071P1	CB 2.0A PANEL MNT	1

15.6. Boot Cap

Part Number	Description	Quantity
132130P1	BOOT CAP	1

16. PIPING ASSY XDO16

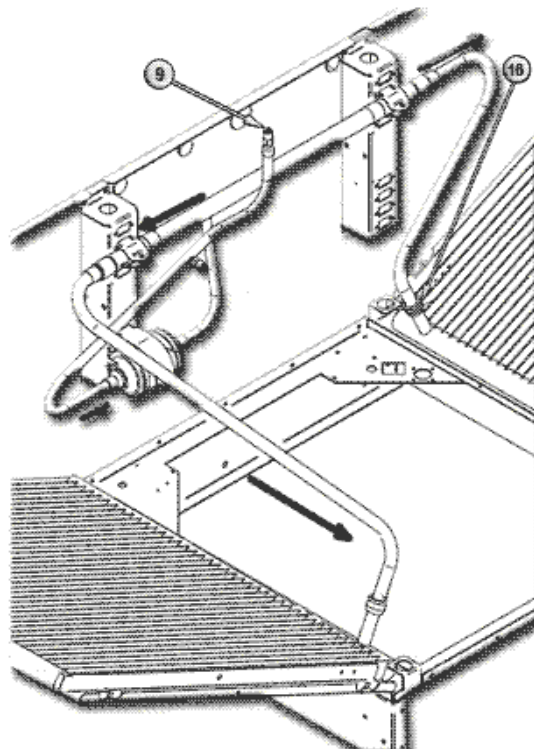

- 9. Valve Core Refrigerant
- 16. Clamp Tube

16.1. Valve Core Refrigerant



Part Number	Description	Quantity
P02-0290	VALVE CORE REFRIGERANT	2

16.2. Clamp Tube



Part Number	Description	Quantity
179061P5	CLAMP TUBE CUSH-A-CLAMP 0.875	2

17. SUPPLY PIPING ASSY XDO 16

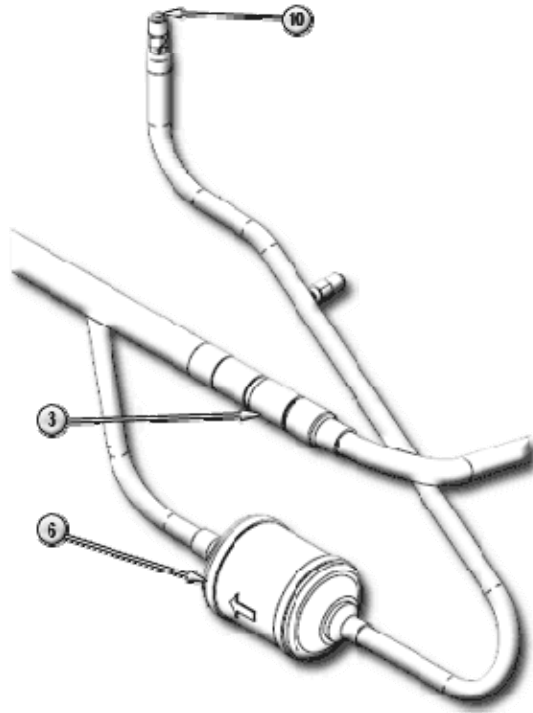

- 3. Regulator
- 6. Filter/Drier
- 10. Valve Access Body

17.1. Regulator



Part Number	Description	Quantity
178083P2	REGULATOR CONSTANT FLOW 3.5"	1

17.2. Filter/Drier



Part Number	Description	Quantity
178082P1	FILTER/DRIER 1/2" SOLDER	1

17.3. Valve Access Body



Part Number	Description	Quantity
P02-0270	VALVE ACCESS BODY 1/4X SWT	2

17.4. Accessories

Part Number	Description
176214P1	Lighting Kit, 120V-1ph-60Hz
176214P2	Lighting Kit, 277V-1ph-60Hz
179401G1	External Mounting Brackets Kits, For One XDO

Liebert XDP

18. XDP EP ASSY 460V 2PUMP

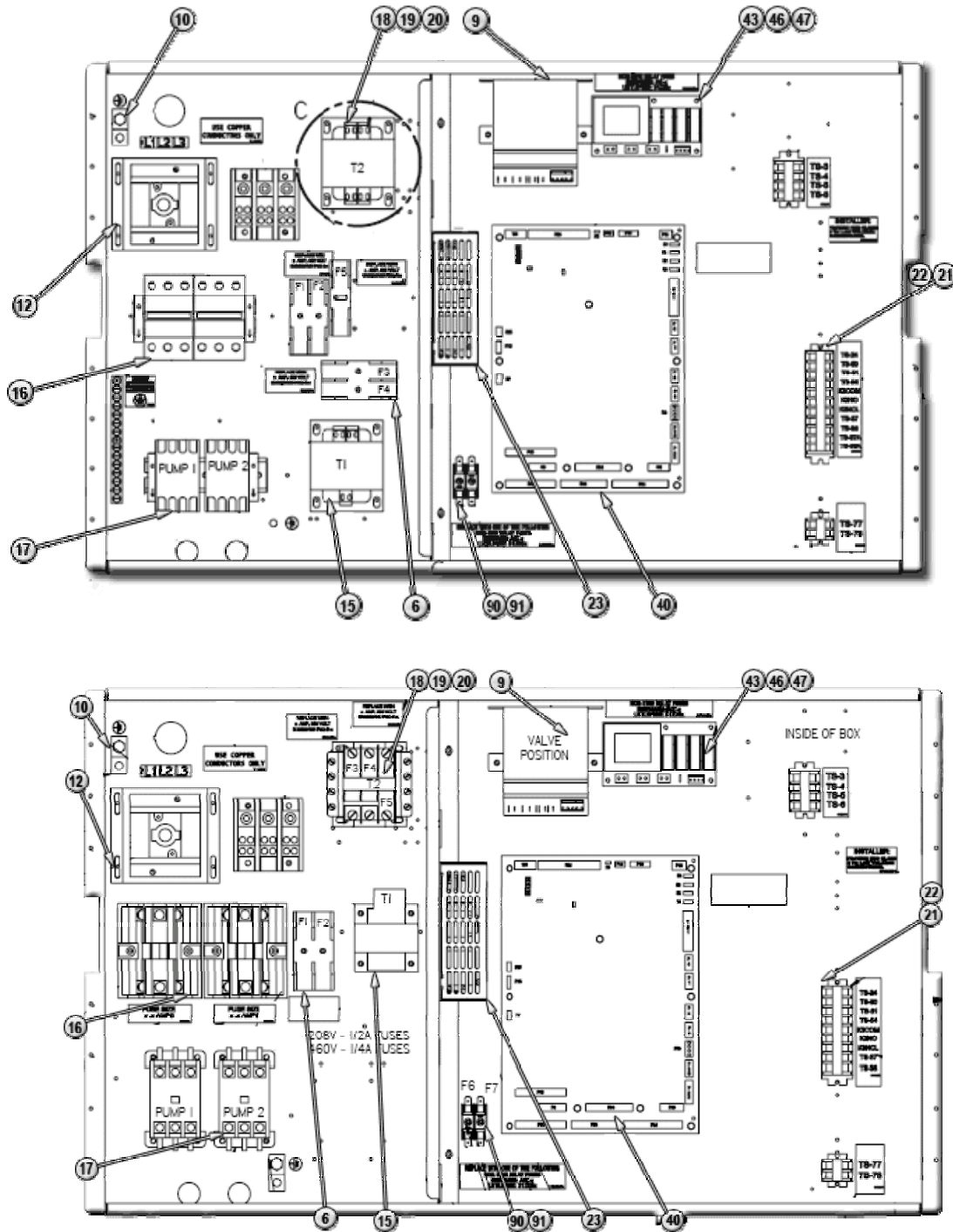

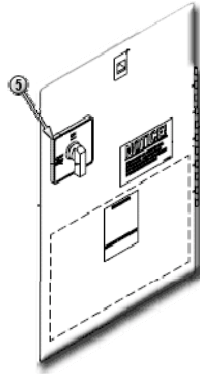

- | | |
|-----------------------|------------------------|
| 5. DeadFront CDU | 20. Fuse |
| 6. FuseBlock | 21. Terminal Strip |
| 9. Transducer | 22. Terminal Strip End |
| 10. Terminal Lug | 23. Power Supply |
| 12. Switch Disconnect | 40. PWA Control |
| 15. Transformer | 43. PWA XFMR/Fuse |
| 16. Circuit Breaker | 46. Fuse Kit |
| 17. Contactor | 47. Fuse Glass |
| 18. Transformer | 90. Fuse Glass |
| 19. Fuse | 91. FuseBlock |

18.1. DeadFront CDU

Part Number	Description	Quantity
171571P1	DEADFRONT 100 KW CDU	1

18.2. FuseBlock



Part Number	Description	Quantity
1C13244P1	FUSEBLOCK 600V 2P 030A	1

18.3. Transducer



Part Number	Description	Quantity
171573P1	XDUCR ANALOG UAT-1	1

18.4. Terminal Lug



Part Number	Description	Quantity
E-362B	TERM LUG MECH #14-2/0 1/4"	2

18.5. Switch Disconnect



Part Number	Description	Quantity
1C23551P1	SW DISC 600V 3PL 40A	1

18.6. Transformer



Part Number	Description	Quantity
127184P2	XFMR 75VA 460-24 50/60HZ	1

18.7. Circuit Breaker



Part Number	Description	Quantity
136241P6	CB MCB 3P 4A/480V ABBS273-K4	2

18.8. Contactor



Part Number	Description	Quantity
136221P1	CONTACTOR 3P16IND/21RES24/50	2

18.9. Transformer



Part Number	Description	Quantity
519458P1	XFMR 100VA 480-240/120 W/FUSE	1

18.10. Fuse



Part Number	Description	Quantity
127977P7	FUSE FNQ-R-1/2	1

18.11. Fuse



Part Number	Description	Quantity
127977P2	FUSE FNQ-R-1/4	4

18.12. Terminal Strip



Part Number	Description	Quantity
132487P1	TERMLSTRIP SECTION 1 POS	15

18.13. Terminal Strip End



Part Number	Description	Quantity
132487P2	TERMLSTRIP SECTION END BARRIER	3

18.14. Power Supply



Part Number	Description	Quantity
140922P1	PWR SPLY UNIV 1.6A 24VDC	1

18.15. PWA Control



Part Number	Description	Quantity
415761G6	PWA UNIVERSAL CONTROL XDP XDWP	1

18.16. PWA XFMR/Fuse



Part Number	Description	Quantity
4C14651G1	PWA ISO XFMR/FUSE INTF	1

18.17. Fuse Kit



Part Number	Description	Quantity
135637P2	FUSE KIT Quantity 8 4A NON-TD FUSES	1

18.18. Fuse Glass



Part Number	Description	Quantity
135409P2	FUSE GLASS 250V 4AMP .25X1.25	4

18.19. Fuse Glass



Part Number	Description	Quantity
135409P4	FUSE GLASS 250V 3AMP .25X1.25	4

18.20. FuseBlock



Part Number	Description	Quantity
176023P1	FUSEBLOCK 1P 300V	2

19. Pump

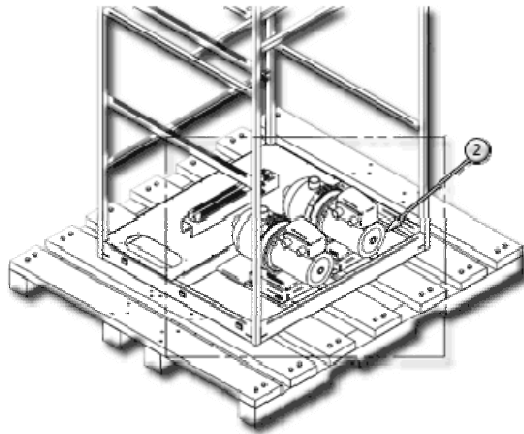

2. Pump

19.1. Kit Pump



Part Number	Description	Quantity
183404G1S	KIT PUMP REPLACEMENT 208V XD	2
183404G2S	KIT PUMP REPLACEMENT 460V XD	2
183404G3S	KIT PUMP REPLACEMENT 400V XD	2

20. Piping Configuration XDP 160

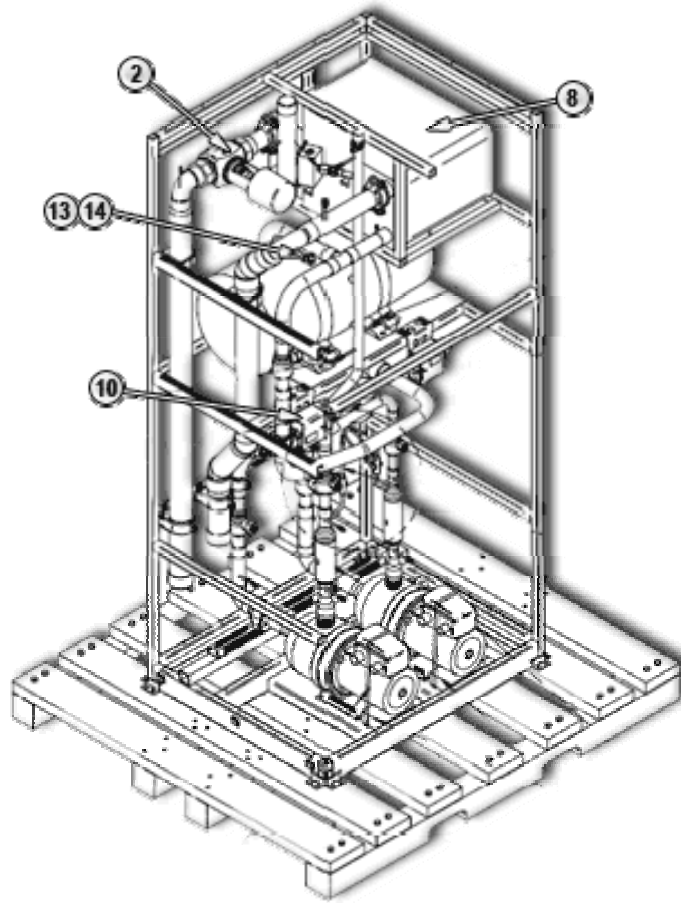

- | | |
|-----------------------------|------------------|
| 2. CW Return Valve Assembly | 13. Valve Relief |
| 8. Heat Exchanger | 14. EII Brass |
| 10. Press Switch | |

20.1. CW Return Valve Assembly

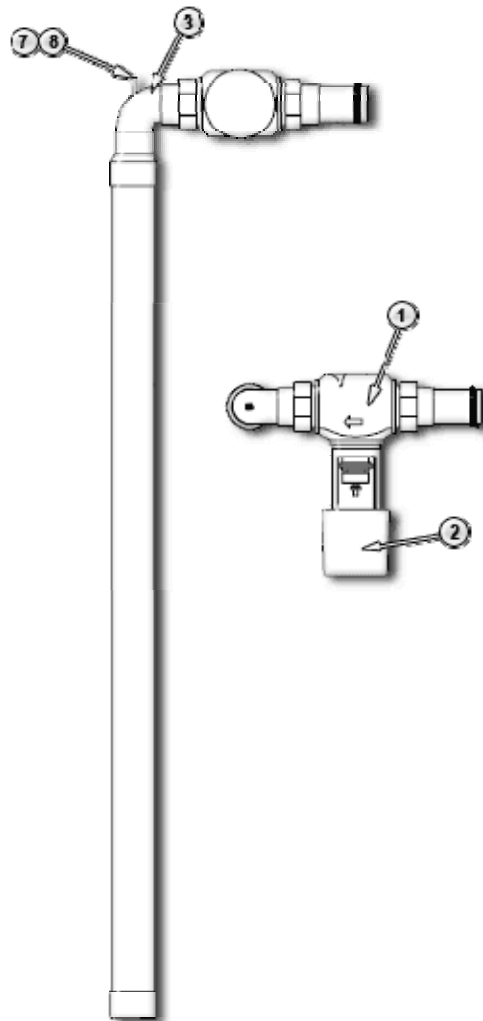

- | | |
|-------------------|----------------------------|
| 2. Valve 2-Way | 13. Valve Access Body |
| 8. Motor | 14. Valve Core Refrigerant |
| 10. ELL Short Rad | |

20.1.1 Valve 2-Way



Part Number	Description	Quantity
159009P3	VALVE 2" 2WAY UNION BODY	1

20.1.2 Motor



Part Number	Description	Quantity
146351P1	MOTOR MOD 24VAC 50/60HZ LRG JC	1

20.1.3 ELL Short Rad

Part Number	Description	Quantity
P-4660	ELL 90 FTGXFTG 2-1/8"SHORT RAD	1

20.1.4 Valve Access Body



Part Number	Description	Quantity
P-3910	VALVE ACCESS BODY 1/4 EXT 2"	1

20.1.5 Valve Core Refrigerant



Part Number	Description	Quantity
P02-0290	VALVE CORE REFRIGERANT	1

20.2. Heat Exchanger



Part Number	Description	Quantity
177810P1	HX 160KW 20X15.5X10 XDP160	1

20.3. Press Switch



Part Number	Description	Quantity
169706P2XD	PRESS SW DIF SPDT 2-26PSI CAL	2

20.4. Valve Relief



Part Number	Description	Quantity
178753P1	VALVE RELIEF 300#1/4MPTX3/8FLR	1

20.5. Ell Brass

Part Number	Description	Quantity
179067P1	ELL BRASS FORG 1/4MPTX1/4FPT	1

21. Suction Line Grundfos

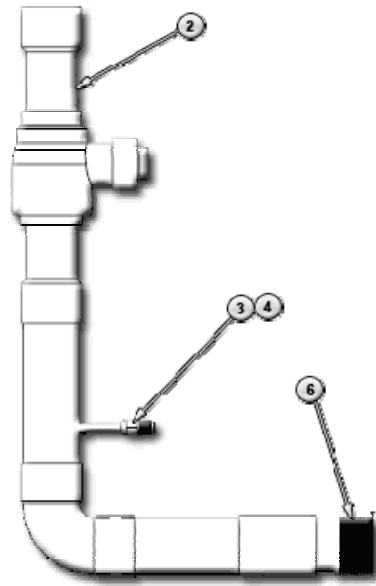

- 2. Valve Ball
- 3. Valve Access Body
- 4. Valve Core Refrigerant
- 6. Adapter

21.1. Valve Ball



Part Number	Description	Quantity
177813P1	VALVE BALL REFRIG 1-5/8"	1

21.2. Valve Access Body



Part Number	Description	Quantity
P-3910	VALVE ACCESS BODY 1/4 EXT 2"	1

21.3. Valve Core Refrigerant



Part Number	Description	Quantity
P02-0290	VALVE CORE REFRIGERANT	1

21.4. Adapter



Part Number	Description	Quantity
180328P1	ADAPTER ST/CU 1-5/8FTGX1-1/4M	1

22. DSCH STACK GRUNDFOS LFT XDP160

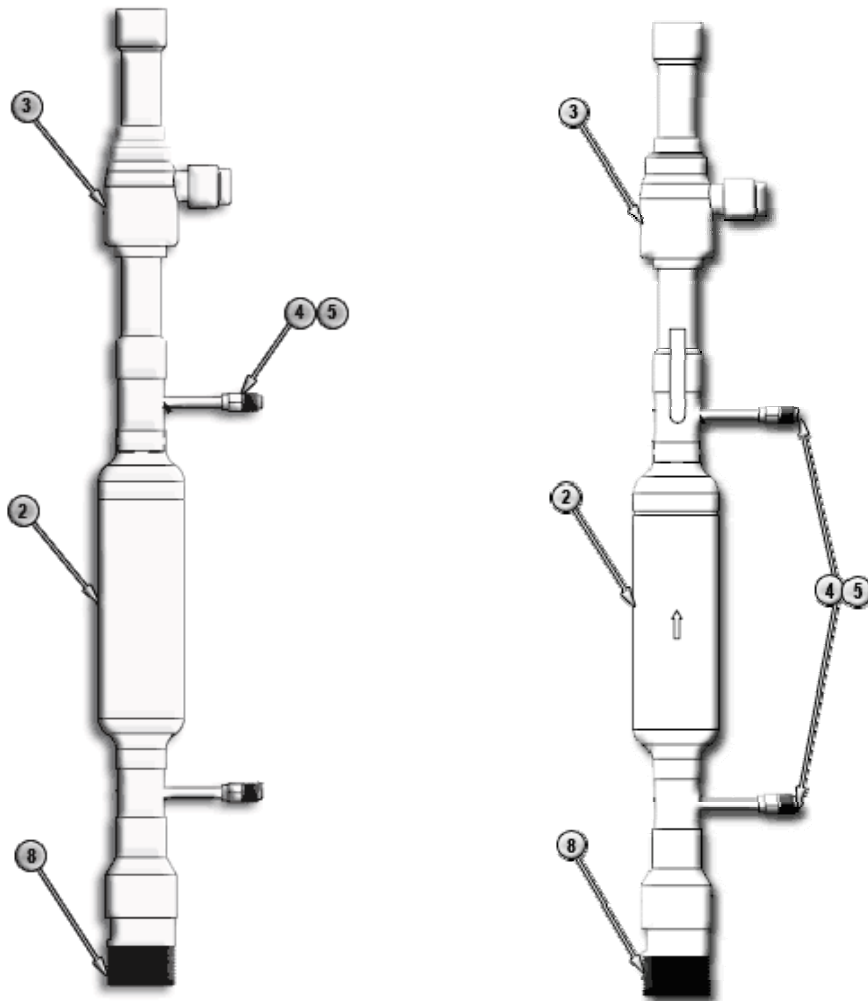

- | | |
|----------------------|---------------------------|
| 2. Valve Check | 5. Valve Core Refrigerant |
| 3. Valve Ball | 8. Adapter |
| 4. Valve Access Body | |

22.1. Valve Check



Part Number	Description	Quantity
1C23493P1	VALVE CHECK 1-1/8" OD	1

22.2. Valve Ball



Part Number	Description	Quantity
1A25919P1	VALVE BALL REFRIG 1-1/8"	1

22.3. Valve Access Body



Part Number	Description	Quantity
P-3910	VALVE ACCESS BODY 1/4 EXT 2"	2

22.4. Valve Core Refrigerant



Part Number	Description	Quantity
P02-0290	VALVE CORE REFRIGERANT	2

22.5. Adapter



Part Number	Description	Quantity
180328P1	ADAPTER ST/CU 1-5/8FTGX1-1/4M	1

23. DSCH STACK GRUNDFOS RT XDP160

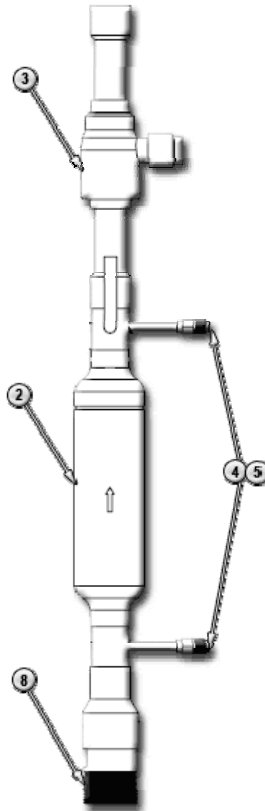

- 2. Valve Ball
- 3. Valve Check
- 4. Valve Access Body
- 5. Valve Core Refrigerant
- 8. Adapter

23.1. Valve Ball



Part Number	Description	Quantity
1A25919P1	VALVE BALL REFRIG 1-1/8"	1

23.2. Valve Check



Part Number	Description	Quantity
1C23493P1	VALVE CHECK 1-1/8" OD	1

23.3. Valve Access Body



Part Number	Description	Quantity
P-3910	VALVE ACCESS BODY 1/4 EXT 2"	2

23.4. Valve Core Refrigerant



Part Number	Description	Quantity
P02-0290	VALVE CORE REFRIGERANT	2

23.5. Adapter



Part Number	Description	Quantity
180328P1	ADAPTER ST/CU 1-5/8FTGX1-1/4M	1

24. DSCH LINE 2GRUNDFOS XDP160



- 5. Valve Access Body
- 7. Valve Core Refrigerant
- 10. Adapter CU

24.1. Valve Access Body



Part Number	Description	Quantity
P-3910	VALVE ACCESS BODY 1/4 EXT 2"	3

24.2. Adapter CU



Part Number	Description	Quantity
P05-4500	ADAPTER CU CXF 5/8"X1/2"	1

24.3. Valve Core Refrigerant



Part Number	Description	Quantity
P02-0290	VALVE CORE REFRIGERANT	3

25. Panel Options Configurations 100KW CDU

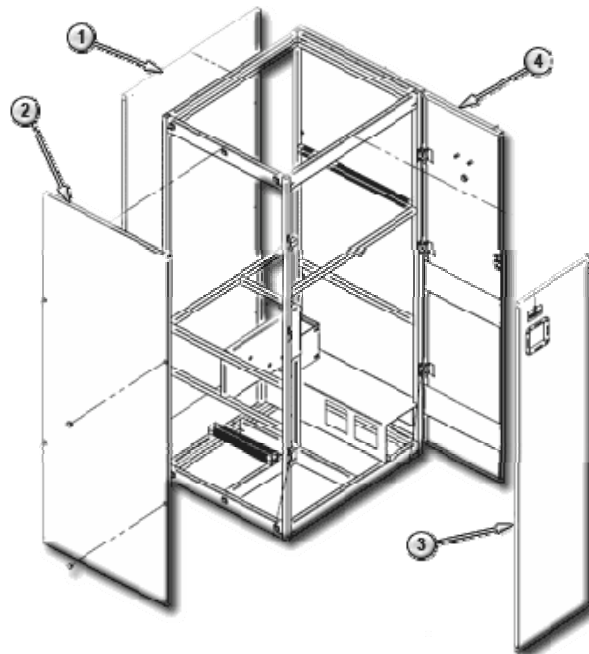

- | | |
|---------------|---------------|
| 1. Back Panel | 3. Left Door |
| 2. Side Panel | 4. Right Door |

25.1. Back Panel

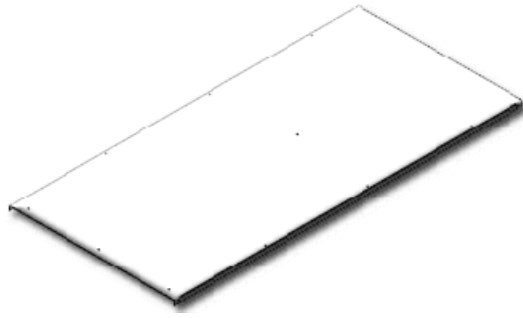

Part Number	Description	Quantity
175831P1	BACK PNL WRAPPER 100KW CDU	1

25.2. Side Panel

Part Number	Description	Quantity
175832P1	SIDE PANEL 100 KW CDU	2

25.3. Left Door

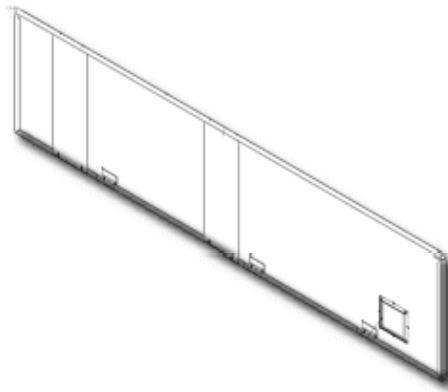

Part Number	Description	Quantity
175833G1	LFT DR PNL ASSY 100KW CDU	1

25.4. Right Door



Part Number	Description	Quantity
175834G1	RHT DR PNL ASSY 100KW CDU	1

26. Filter Drier Replace Assembly

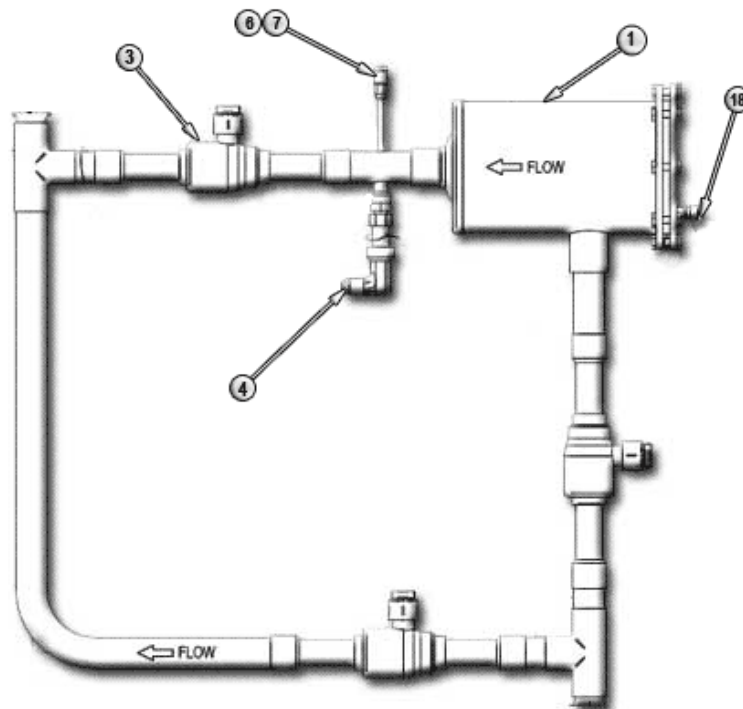

- | | |
|-----------------|---------------------------|
| 1. Filter Drier | 6. Valve Access Body |
| 3. Valve Ball | 7. Valve Core Refrigerant |
| 4. Valve Relief | 18. Valve Access |

26.1. Filter Drier



Part Number	Description	Quantity
1A21683P4	FILTER DRIER REPL C489 1.1 ODF	1

26.2. Valve Ball



Part Number	Description	Quantity
1A25919P1	VALVE BALL REFRIG 1-1/8"	3

26.3. Valve Relief



Part Number	Description	Quantity
178753P1	VALVE RELIEF 300#1/4MPTX3/8FLR	1

26.4. Valve Access Body



Part Number	Description	Quantity
P-3910	VALVE ACCESS BODY 1/4 EXT 2"	1

26.5. Valve Core Refrigerant



Part Number	Description	Quantity
P02-0290	VALVE CORE REFRIGERANT	1

26.6. Valve Access



Part Number	Description	Quantity
175817P1	VALVE ACCESS BODY ONLY 1/4"NPT	1

27. Accessories

Part Number	Description
180197G1	Bypass Flow Controller

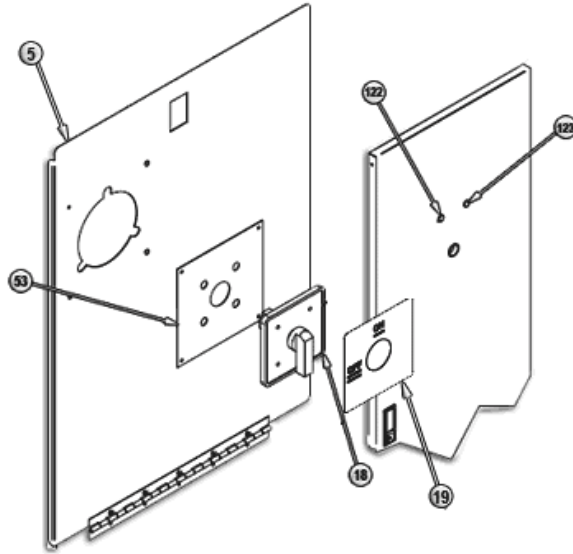

- | | | | |
|-----|---------------------------|------|-----------------------|
| 2. | Fuse Kit | 23. | Power Supply |
| 5. | DeadFront XDP | 28. | Fuseblock |
| 6. | Transformer | 29. | Fuse Dual Element |
| 9. | Transducer | 40. | PWA Universal Control |
| 10. | Terminal Lug | 43. | PWA ISO XFMR/FUSE |
| 12. | Standoff Disconnect | 46. | Fuse Kit |
| 13. | Collar Locking Disconnect | 47. | Fuse Glass 4A |
| 14. | Switch Disconnect | 53. | Plate Disconnect |
| 15. | Transformer | 100. | FuseBlock |
| 16. | Circuit Breaker | 101. | Fuse Glass 030A |
| 17. | Contactor | 102. | Fuse FNQ R-1/4 |
| 18. | Handle Disconnect | 103. | Fuse FNQ R-1/2 |
| 19. | Label Disconnect | 122. | Lamp (Green) |
| 21. | Terminal Strip | 123. | Lamp (Red) |
| 22. | Terminal Strip End | | |

28.1. Fuse Kit

Part Number	Description	Quantity
176024G3	FUSE KIT CDU - 3 AMP AGC	1

28.2. DeadFront XDP



Part Number	Description	Quantity
179375P1	DEADFRONT XDP	1

28.3. Transformer



Part Number	Description	Quantity
519458P1	XFMR 100VA 480-240/120 W/FUSE	1



Part Number	Description	Quantity
182893P1	XFMR 75VA 400-120/240 50/60 CE	1

28.4. Transducer



Part Number	Description	Quantity
171573P1	XDUCR ANALOG UAT-1	1

28.5. Terminal Lug



Part Number	Description	Quantity
E-362B	TERM LUG MECH #14-2/0 1/4"	1

28.6. Standoff Disconnect



Part Number	Description	Quantity
179810P1	STANDOFF DISCONNECT XDC/XDP	1

28.7. Collar Locking Disconnect



Part Number	Description	Quantity
1C18354P1	COLLAR LKG DISC W/2 SCREWS KM	1

28.8. Switch Disconnect



Part Number	Description	Quantity
1C18351P1	SW DISC 600V 3PL 100A	1

28.9. Transformer



Part Number	Description	Quantity
127184P2	XFMR 75VA 460-24 50/60HZ	1

28.10. Circuit Breaker



Part Number	Description	Quantity
136241P6	CB MCB 3P 4A/480V ABBS273-K4	2

28.11. Contactor



Part Number	Description	Quantity
1362221	CONTACTOR 3P16IND/21RES24/50	2

28.12. Handle Disconnect



Part Number	Description	Quantity
1C18352P1	HANDLE DISC SWT/FACEPLATE K/M	1

28.13. Label Disconnect



Part Number	Description	Quantity
4D10624P1	LABEL DISCONNECT K/M LIEBERT	1

28.14. Terminal Strip



Part Number	Description	Quantity
132487P1	TERMLSTRIP SECTION 1 POS	15

28.15. Terminal Strip End



Part Number	Description	Quantity
132487P2	TERMLSTRIP SECTION END BARRIER	3

28.16. Power Supply



Part Number	Description	Quantity
140992P1	PWR SPLY UNIV 1.6A 24VDC	1

28.17. FuseBlock



Part Number	Description	Quantity
136811P1	FUSEBLOCK BUSS JP600V 30A 3P	2

28.18. Fuse Dual Element



Part Number	Description	Quantity
136821P10	FUSE DUAL ELMNT "J" 600V 10.0A	6

28.19. PWA Universal Control



Part Number	Description	Quantity
415761G6	PWA UNIVERSAL CONTROL XDP XDWP	1

28.20. PWA ISO XFMR/FUSE



Part Number	Description	Quantity
4C1465G1	PWA ISO XFMR/FUSE INTF	1

28.21. Fuse Kit



Part Number	Description	Quantity
135637P2	FUSE KIT Quantity 8 4A NON-TD FUSES	2

28.22. Fuse Glass



Part Number	Description	Quantity
135409P2	FUSE GLASS 250V 4AMP .25X1.25	4

28.23. Plate Disconnect



Part Number	Description	Quantity
1C18707P1	PLATE DISC K/M	1

28.24. FuseBlock



Part Number	Description	Quantity
167556P1	FUSEBLOCK 600V 30AMP	1

28.25. Fuse Glass



Part Number	Description	Quantity
1C13244P1	FUSEBLOCK 600V 2P 030A	1

28.26. Fuse FNQ



Part Number	Description	Quantity
127977P2	FUSE FNQ-R-1/4	4

28.27. Fuse FNQ



Part Number	Description	Quantity
127977P7	FUSE FNQ-R-1/2	1

28.28. Lamp



Part Number	Description	Quantity
E-0580	LAMP GREEN 28V	1

28.29. Lamp



Part Number	Description	Quantity
E-0570	LAMP RED 28V	1

29. DSCH PUMP STACK ASSY XDWP 60HZ

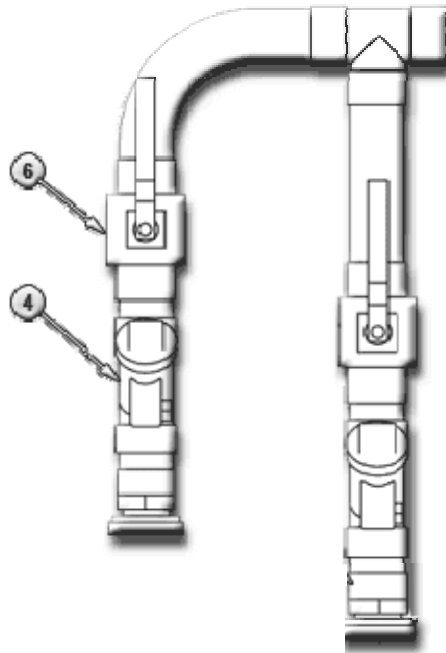

- 4. Valve Check
- 6. Valve Ball Switch

29.1. Valve Check



Part Number	Description	Quantity
P05-3730	VALVE CHECK 2-1/8"ODBRONZE SWT	2

29.2. Valve Ball Switch



Part Number	Description	Quantity
1C14431P6	VALVE BALL BRONZE 2" SWT F/P	2

30. BASE ASSY CONFIG XDWP

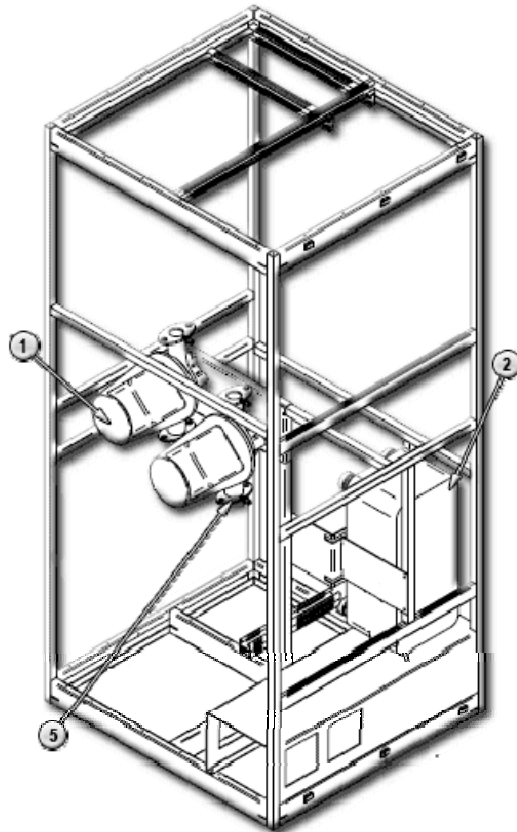

1. Pump
2. Heat Exchanger FlatPlate
5. Valve Access Body

30.1. Pump



Part Number	Description	Quantity
175821P2	PUMP 1.5HP 460-3-60	2

30.2. Heat Exchanger FlatPlate



Part Number	Description	Quantity
182715P1	HEAT EXCHGR FLATPLATE VIC 2"	1

30.3. Valve Access Body



Part Number	Description	Quantity
175817P1	VALVE ACCESS BODY ONLY 1/4"NPT	4

31. VLV/CSTM/STND CONN XDWP

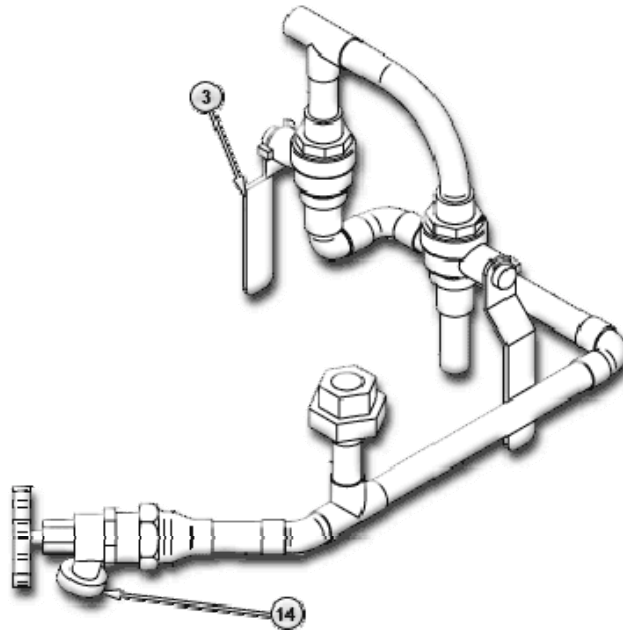

- 3. Valve Ball Bronze
- 14. Valve Boiler

31.1. Valve Ball Bronze



Part Number	Description	Quantity
1C14431P4	VALVE BALL BRONZE 1/2SWT F/P	2

31.2. Valve Boiler



Part Number	Description	Quantity
P07-0350	VALVE BOILER DRAIN3/4"NPT MALE	1

32. STAND PIPE ASSY XDWP

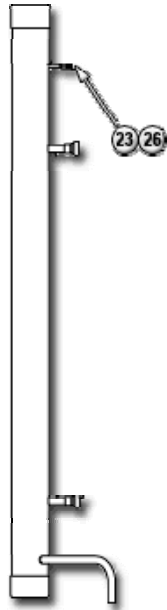

- 23. Valve 2-Way
- 26. Valve Core Refrigerant

32.1. Valve 2-Way



Part Number	Description	Quantity
P-3910	VALVE 2" 2WAY UNION BODY	1

32.2. Valve Core Refrigerant



Part Number	Description	Quantity
P02-0290	VALVE CORE REFRIGERANT	1

33. PIPING CONFIG XDWP 60HZ

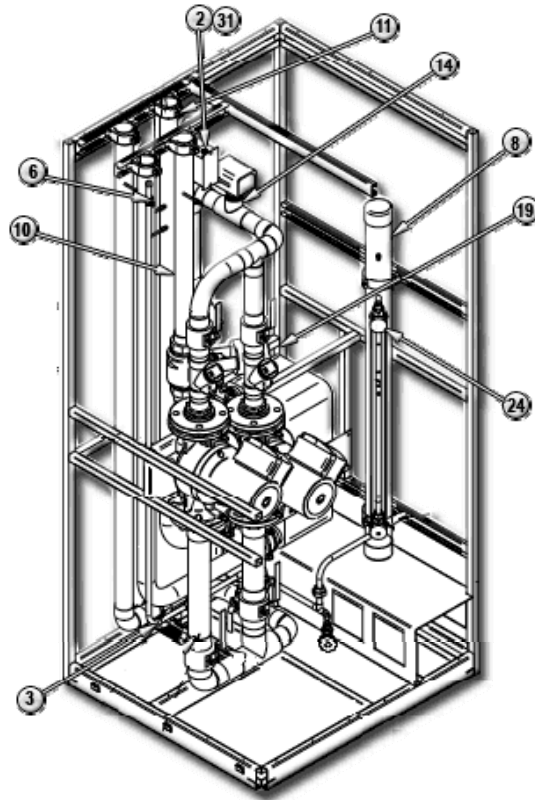

- | | | | |
|-----|-----------------------|-----|------------------------|
| 2. | Transducer | 11. | Supply Line Assembly |
| 3. | Clamp Tube | 14. | Flow Switch Assembly |
| 6. | Clamp Insulated Metal | 19. | Motor |
| 8. | Stand Pipe Assy | 24. | Gauge Water Compressor |
| 10. | Return Line | 31. | Thermowell Brass |

33.1. Transducer



Part Number	Description	Quantity
183803P1	TEMP TRANSDUCER 0-100F	1

33.2. Clamp Tube



Part Number	Description	Quantity
179061P2	CLAMP TUBE CUSH-A-CLAMP 2.125	5

33.3. Clamp Insulated Metal



Part Number	Description	Quantity
P-3460	CLAMP INSULATED METAL 5/8"	2

33.4. Stand Pipe Assy

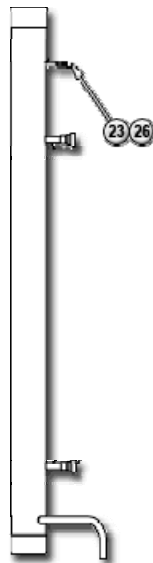

- 23. Valve Access Body
- 26. Valve Core Refrigerant

31.4.1 Valve Access Body



Part Number	Description	Quantity
P-3910	VALVE ACCESS BODY 1/4 EXT 2"	1

31.4.2 Valve Core Refrigerant



Part Number	Description	Quantity
P02-0290	VALVE CORE REFRIGERANT	1

33.5. CW Return Line

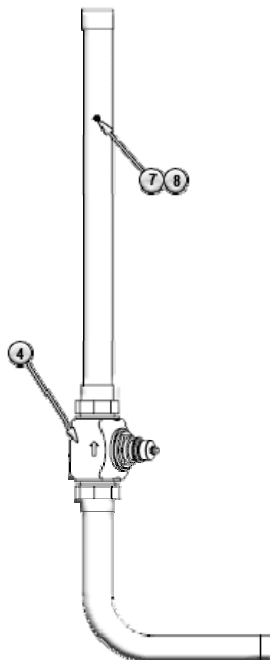

- 4. Valve 2-Way
- 7. Valve Access Body
- 8. Valve Core Refrigerant

31.5.1 Valve 2-Way



Part Number	Description	Quantity
159009P3	VALVE 2" 2WAY UNION BODY	1

31.5.2 Valve Access Body



Part Number	Description	Quantity
P-3910	VALVE 2" 2WAY UNION BODY	1

31.5.3 Valve Core Refrigerant



Part Number	Description	Quantity
P02-0290	VALVE CORE REFRIGERANT	1

33.6. Supply Line Assembly



- 4. Valve 2-Way
- 5. Valve Core Refrigerant

31.6.1 Valve 2-Way



Part Number	Description	Quantity
P-3910	VALVE 2" 2WAY UNION BODY	1

31.6.2 Valve Core Refrigerant



Part Number	Description	Quantity
P02-0290	VALVE CORE REFRIGERANT	1

33.7. Flow Switch Assembly

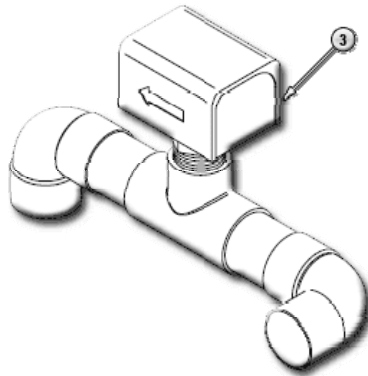

3. Switch Flow

31.7.1 Switch Flow



Part Number	Description	Quantity
127998P4	SW FLOW ASSY 2-1/8"	1

33.8. Motor



Part Number	Description	Quantity
146351P1	MOTOR MOD 24VAC 50/60HZ LRG JC	1

33.9. Gauge Water Compressor



Part Number	Description	Quantity
1A34258P7	GAUGE WATER COMP TK KIT 30"	1

33.10. Thermowell Brass



Part Number	Description	Quantity
183802P1	THERMOWELL 2"BRASS 1/2"NPT	1

34. SUCTION PUMP STACK XDWP

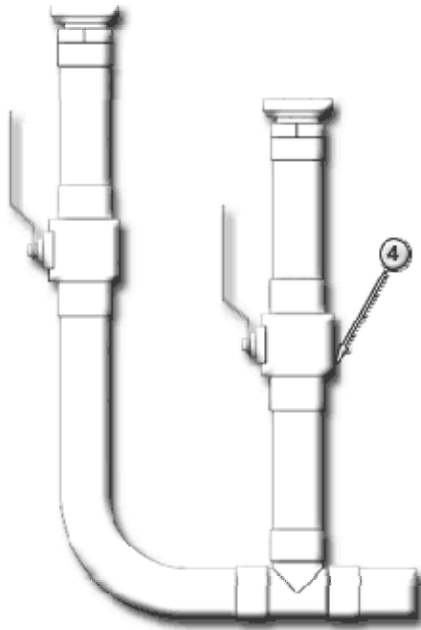

4. Valve Ball Switch

34.1. Valve Ball Switch



Part Number	Description	Quantity
1C14431P6	VALVE BALL BRONZE 2" SWT F/P	2

Liebert XDWR

35. BASE FRAME ASSY RACKCOOLER

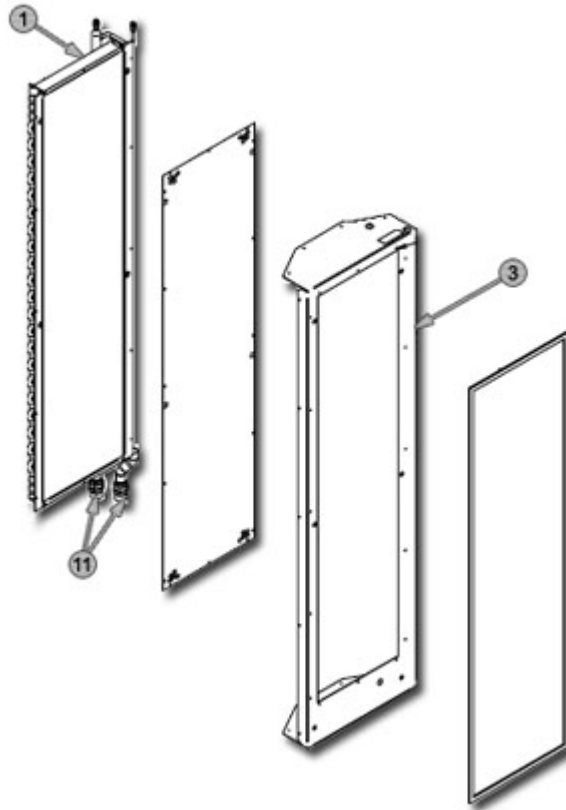

- 1. Coil Complete Rack Cooler
- 3. Box Rack Cooler
- 11. Adapter Brass

35.1. Coil Complete Rack Cooler

Part Number	Description	Quantity
171421G1	COIL COMPLETE RACK COOLER	1

35.2. Box Rack Cooler

Part Number	Description	Quantity
171203P1	BOX RACK COOLER	1

35.3. Adapter Brass

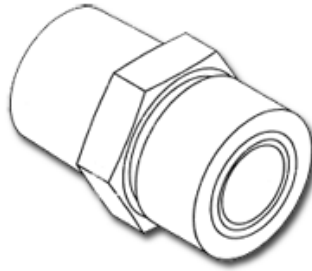

Part Number	Description	Quantity
171449P1	ADAPTER BRASS 3/4 MNPT X SEAL	2

36. COIL COMPLETE RACK COOLER

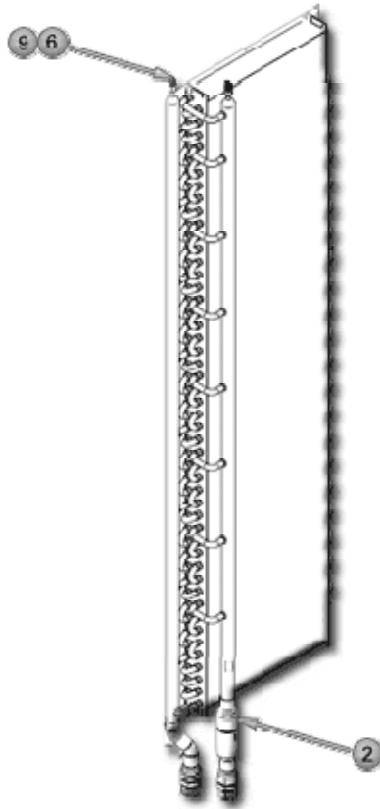

- 2. Valve Flo-RGLTR
- 6. Valve Core Refrigerant
- 9. Valve Access Body

36.1. Valve Flo-RGLTR

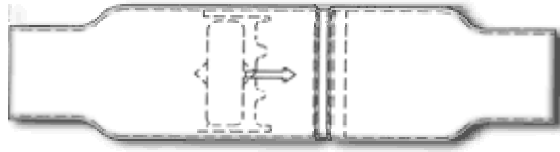

Part Number	Description	Quantity
171218P1	VALVE FLO-RGLTR 6.0G 3/4"	1

36.2. Valve Core Refrigerant



Part Number	Description	Quantity
P02-0290	VALVE CORE REFRIGERANT	2

36.3. Valve Access Body



Part Number	Description	Quantity
P-391B	VALVE ACCESS BODY 1/4 EXT 1"	2

37. HOSE KIT PACKAGING ASSEMBLY

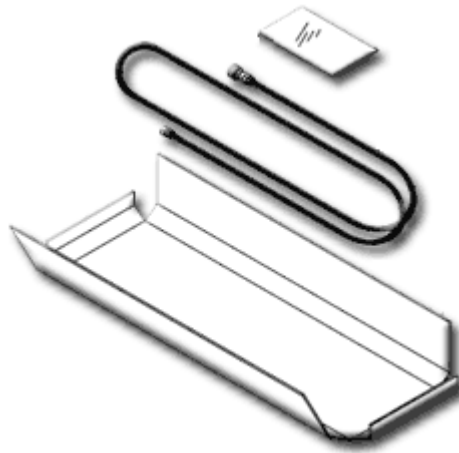

Part Number	Description
177184G1	Hose Kit Packaging Assembly

38. PANEL FAN RACKCOOLER

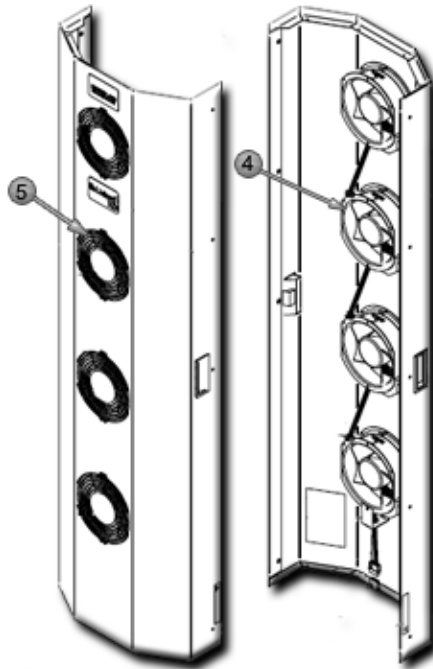

- 4. Fan Axial
- 5. Finger Guard

38.1. Fan Axial

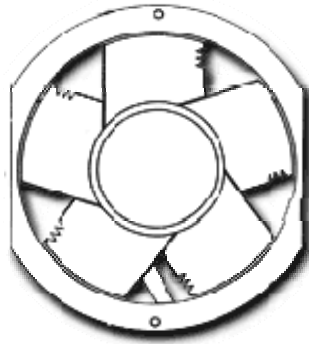

Part Number	Description	Quantity
12-796524-11	FAN AXIAL 300CFM 115VAC .36AMP	4
171216P1	FAN AXIAL 50/60 HZ RACKCOOLER	4

38.2. Finger Guard

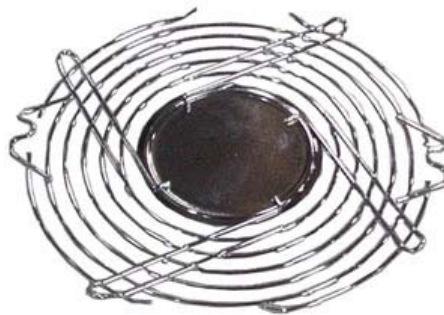

Part Number	Description	Quantity
516703P1	FINGER GUARD 6"	4

39. Accessories

Part Number	Description
RC08C-LHAK	Left-Hand-Latch Hose Adapter Kit

XD Field Installed Accessories

Part Number	Description
181399G51	Field Piping Kit, 10ft (3.05m) With 5 Ports, 1 Supply and 1 Return Pipe, Supply 1-1/8" and Return 2-1/8"
181399G52	Field Piping Kit, 10ft (3.05m) With 5 Ports, 2 Supply and 2 Return Pipe, Supply 1-1/8" and Return 2-1/8"
181399G21	Field Piping Kit, 8ft (2.44m) With 2 Ports, 1 Supply and 1 Return Pipe, Supply 1-1/8" and Return 2-1/8">
181399G22	Field Piping Kit, 8ft (2.44m) With 2 Ports, 2 Supply and 2 Return Pipe, Supply 1-1/8" and Return 2-1/8"
183167G51	Field Piping Kit, 10ft (3.05m) With 5 Ports, 1 Supply and 1 Return Pipe, Supply 1-3/8" and Return 2-5/8"
183167G52	Field Piping Kit, 10ft (3.05m) With 5 Ports, 2 Supply and 2 Return Pipe, Supply 1-3/8" and Return 2-5/8"
183167G21	Field Piping Kit, 8ft (2.44m) With 2 Ports, 1 Supply and 1 Return Pipe, Supply 1-3/8" and Return 2-5/8"
183167G22	Field Piping Kit, 8ft (2.44m) With 2 Ports, 2 Supply and 2 Return Pipe, Supply 1-3/8" and Return 2-5/8"
182842G51	Field Piping Kit, 10ft (3.05m) With 5 Ports, 1 Supply and 1 Return Pipe, Supply 1-1/8" and Return 2-1/8", Exporting Crating
182842G52	Field Piping Kit, 10ft (3.05m) With 5 Ports, 2 Supply and 2 Return Pipe, Supply 1-1/8" and Return 2-1/8", Exporting Crating
182272G21	Field Piping Kit, 8ft (2.44m) With 2 Ports, 1 Supply and 1 Return Pipe, Supply 1-1/8" and Return 2-1/8", Exporting Crating
182272G22	Field Piping Kit, 8ft (2.44m) With 2 Ports, 2 Supply and 2 Return Pipe, Supply 1-1/8" and Return 2-1/8", Exporting Crating
183170G51	Field Piping Kit, 10ft (3.05m) With 5 Ports, 1 Supply and 1 Return Pipe, Supply 1-3/8" and Return 2-5/8", Exporting Crating
183170G52	Field Piping Kit, 10ft (3.05m) With 5 Ports, 2 Supply and 2 Return Pipe, Supply 1-3/8" and Return 2-5/8", Exporting Crating
183170G21	Field Piping Kit, 8ft (2.44m) With 2 Ports, 1 Supply and 1 Return Pipe, Supply 1-3/8" and Return 2-5/8", Exporting Crating
183170G22	Field Piping Kit, 8ft (2.44m) With 2 Ports, 2 Supply and 2 Return Pipe, Supply 1-3/8" and Return 2-5/8", Exporting Crating
183169G1	Connection Port Kit, 1 Supply and 1 Return Pipe, Supply 1-3/8" and Return 2-5/8"
183169G2	Connection Port Kit, 1 Supply and 1 Return Pipe, Supply 1-3/8" and Return 2-5/8"